



**INDEPENDENT REDISTRICTING COMMISSION
REGULAR MEETING**

**Wednesday, December 15, 2021
6:00 PM**

Commission Members:

DISTRICT 1 – TERRY NICOL
DISTRICT 2 – JESSE SUSSELL
DISTRICT 3 – LISA M. TRAN
DISTRICT 4 – CURTIS W. HANSON
AT-LARGE – DELORES COOPER
AT-LARGE – CARLY MICHELE ALEJOS
AT-LARGE – SHERRY SMITH

DISTRICT 5 – WINSTON RHODES
DISTRICT 6 – ELISABETH WATSON
DISTRICT 7 – RANA CHO
DISTRICT 8 – ANDREW FOX
AT-LARGE – LUPE GALLEGOS-DIAZ
AT-LARGE – RONALD K. CHOY

PUBLIC ADVISORY: THIS MEETING WILL BE CONDUCTED EXCLUSIVELY THROUGH VIDEOCONFERENCE AND TELECONFERENCE

Pursuant to Government Code Section 54953(e) and the state declared emergency, this meeting of the Independent Redistricting Commission will be conducted exclusively through teleconference and Zoom videoconference. The COVID-19 state of emergency continues to directly impact the ability of the members to meet safely in person and presents imminent risks to the health of attendees. Therefore, no physical meeting location will be available.

To access the meeting remotely using the internet: Join from a PC, Mac, iPad, iPhone, or Android device: Use URL <https://us02web.zoom.us/j/89840594390>. If you do not wish for your name to appear on the screen, then use the drop down menu and click on "rename" to rename yourself to be anonymous. To request to speak, use the "raise hand" icon on the screen.

To join by phone: Dial **1-669-900-9128** or **1-877-853-5257 (Toll Free)** and Enter Meeting ID: **898 4059 4390**. If you wish to comment during the public comment portion of the agenda, press *9 and wait to be recognized by the Chair.

Written communications submitted by mail or e-mail to the Independent Redistricting Commission by 5:00 p.m. the Friday before the Commission meeting will be distributed to the members of the Commission in advance of the meeting and retained as part of the official record.

AGENDA

Roll Call

Public Comment on Non-Agenda Matters

Minutes for Approval

Draft minutes for the Commission's consideration and approval.

1. Minutes - December 1, 2021

Commission Action Items

The public may comment on each item listed on the agenda for action as the item is taken up.

2. **Presentation on Redistricting Criteria in City and State Law**
From: Independent Redistricting Commission
Contact: Mark Numainville, Commission Secretary, (510) 981-6900
3. **Map Review and Development Process**
From: Independent Redistricting Commission
Contact: Mark Numainville, Commission Secretary, (510) 981-6900
4. **Review and Modifications to Map Matrix**
From: Independent Redistricting Commission
Contact: Mark Numainville, Commission Secretary, (510) 981-6900
5. **Discussion and Definition of Themes Identified in Public Maps**
From: Independent Redistricting Commission
Contact: Mark Numainville, Commission Secretary, (510) 981-6900

Subcommittee Reports

Subcommittees may provide verbal reports on their activities and discuss topics under their purview with the full commission. To take action on a subcommittee item, the topic must be agendized on the commission's Action Calendar.

6. **Appointment of Final Report Drafting Subcommittee**
7. **Changes to Map and COI Subcommittee Membership**
8. **Report from Map and COI Committee**
9. **Report from Outreach Committee**

Items for Future Agendas and Meeting Calendar

- Discussion of items to be added to the next scheduled meeting calendar
- Discussion and possible modifications to the meeting calendar

Adjournment

~~~~~  
*This meeting will be conducted in accordance with the Brown Act, Government Code Section 54953. Any member of the public may attend this meeting. Questions regarding this matter may be addressed to Mark Numainville, City Clerk, (510) 981-6900.*

*Any writings or documents provided to a majority of the Independent Redistricting Commission regarding any item on this agenda are on file in the City Clerk Department at 2180 Milvia Street, 1st Floor, Berkeley, CA and are available upon request by contacting the City Clerk Department at (510) 981-6908 or [redistricting@cityofberkeley.info](mailto:redistricting@cityofberkeley.info).*

*Written communications addressed to the Independent Redistricting Commission and submitted to the City Clerk Department will be distributed to the Commission prior to the meeting.*

*Communications to the Independent Redistricting Commission are public record and will become part of the City's electronic records, which are accessible through the City's website. Please note: e-mail addresses, names, addresses, and other contact information are not required, but if included in any communication to the Independent Redistricting Commission, will become part of the public record. If you do not want your e-mail address or any other contact information to be made public, you may deliver communications via U.S. Postal Service to the City Clerk Department at 2180 Milvia Street. If you do not want your contact information included in the public record, please do not include that information in your communication. Please contact the City Clerk Department for further information.*

### COMMUNICATION ACCESS INFORMATION:

If you need ASL or Spanish translation services, please contact the City Clerk's Office at (510) 981-6908 or [redistricting@cityofberkeley.info](mailto:redistricting@cityofberkeley.info) at least three business days in advance of the meeting.



To request a disability-related accommodation(s) to participate in the meeting, including auxiliary aids or services, please contact the Disability Services specialist at (510) 981-6418 (V) or (510) 981-6347 (TDD) at least three business days before the meeting date.

~~~~~  
I hereby certify that the agenda for this meeting of the Independent Redistricting Commission was posted at the display case located near the walkway in front of the Maudelle Shirek Building, 2134 Martin Luther King Jr. Way, as well as on the City's website, on December 9, 2021.

A handwritten signature in black ink that reads "Mark Numainville".

Mark Numainville, City Clerk

Communications

Communications submitted to the Independent Redistricting Commission are on file in the City Clerk Department at 2180 Milvia Street, 1st Floor, Berkeley, CA and are available upon request by contacting the City Clerk Department at (510) 981-6908 or redistricting@cityofberkeley.info or may be viewed through [Records Online](#).

Item #4: Review and Modifications to Map Matrix

29. Commissioner Ronald Choy (3)

Community of Interest Form Submissions

30. Vincent Casalaina

31. Greysonne Coomes

UC Student Population

32. Janis Ching

**INDEPENDENT REDISTRICTING COMMISSION
REGULAR MEETING MINUTES**

**Wednesday, December 1, 2021
6:00 PM**

Commission Members:

DISTRICT 1 – TERRY NICOL
DISTRICT 2 – JESSE SUSSELL
DISTRICT 3 – LISA M. TRAN
DISTRICT 4 – CURTIS W. HANSON
AT-LARGE – DELORES COOPER
AT-LARGE – CARLY MICHELE ALEJOS
AT-LARGE – SHERRY SMITH

DISTRICT 5 – WINSTON RHODES
DISTRICT 6 – ELISABETH WATSON
DISTRICT 7 – RANA CHO
DISTRICT 8 – ANDREW FOX
AT-LARGE – LUPE GALLEGOS-DIAZ
AT-LARGE – RONALD K. CHOY

PUBLIC ADVISORY: THIS MEETING WILL BE CONDUCTED EXCLUSIVELY THROUGH VIDEOCONFERENCE AND TELECONFERENCE

Pursuant to Government Code Section 54953(e) and the state declared emergency, this meeting of the Independent Redistricting Commission will be conducted exclusively through teleconference and Zoom videoconference. The COVID-19 state of emergency continues to directly impact the ability of the members to meet safely in person and presents imminent risks to the health of attendees. Therefore, no physical meeting location will be available.

To access the meeting remotely using the internet: Join from a PC, Mac, iPad, iPhone, or Android device: Use URL <https://us02web.zoom.us/j/84948847183> If you do not wish for your name to appear on the screen, then use the drop down menu and click on "rename" to rename yourself to be anonymous. To request to speak, use the "raise hand" icon on the screen.

To join by phone: Dial **1-669-900-9128 or 1-877-853-5257 (Toll Free)** and Enter Meeting ID: **849 4884 7183**. If you wish to comment during the public comment portion of the agenda, press *9 and wait to be recognized by the Chair.

Written communications submitted by mail or e-mail to the Independent Redistricting Commission by 5:00 p.m. the Friday before the Commission meeting will be distributed to the members of the Commission in advance of the meeting and retained as part of the official record.

Roll Call: 6:03 p.m.

Present: Cho, Choy, Cooper, Fox, Gallegos-Diaz, Hanson, Nicol, Rhodes, Smith, Sussell, Tran, Watson

Absent: Alejos

Public Comment on Non-Agenda Matters – 1 speaker

Minutes for Approval

Draft minutes for the Commission's consideration and approval.

1. Minutes - November 17, 2021

Action: M/S/C (Rhodes/Hanson) to approve the minutes of 11/17/2021.

Vote: Ayes - Cho, Choy, Cooper, Fox, Gallegos-Diaz, Hanson, Nicol, Rhodes, Smith, Sussell, Tran, Watson; Noes – None; Abstain – None; Absent – Alejos.

Commission Action Items

The public may comment on each item listed on the agenda for action as the item is taken up.

2. Appointment of At-Large Alternate Commissioner

From: Independent Redistricting Commission

Contact: Mark Numainville, Commission Secretary, (510) 981-6900

Action: 1 speaker. M/S/C (Hanson/Cho) to select Matthew R. Lewis as the first choice for 5th At-Large Alternate and authorize appointment of Frances Dede Dewey as 5th At-Large Alternate if Matthew R. Lewis declines the appointment.

Vote: Ayes - Cho, Choy, Cooper, Fox, Gallegos-Diaz, Hanson, Nicol, Rhodes, Smith, Sussell, Tran, Watson; Noes – None; Abstain – None; Absent – Alejos.

3. Review of Community of Interest (COI) Form Submissions

From: Independent Redistricting Commission

Recommendation: Review the information provided by the Map and Community of Interest Review Subcommittee and determine if there are changes needed to the COI classification and analysis.

Contact: Mark Numainville, Commission Secretary, (510) 981-6900

Action: 1 speaker. The Commission discussed the classification of the form on the matrix, made adjustments to #10 and #25 to designate them as mappable, and discussed the use and impact of COI forms on the overall process.

4. Review of Map Submissions

From: Independent Redistricting Commission

Recommendation: Review the proposed map review and development process, make any needed changes, and take action to adopt.

Contact: Mark Numainville, Commission Secretary, (510) 981-6900

Action: 1 speaker. The Commission discussed the proposed map development process and calendar, adjusted the process to move up the 1/27 items to 1/10, to request in-person meetings, and to schedule the additional map review meeting for after the February 28 meeting.

Action: M/S/C (Nicol/Rhodes) to appoint Commissioners Nicol and Sussell to the Mao and COI Review Subcommittee.

Vote: Ayes - Cho, Choy, Cooper, Fox, Gallegos-Diaz, Hanson, Nicol, Rhodes, Smith, Sussell, Tran, Watson; Noes – None; Abstain – None; Absent – Alejos.

Subcommittee Reports

5. Verbal Report from Map and Community of Interest Review Subcommittee

- Completed under Item 2 and Item 3

Items for Future Agendas and Meeting Calendar

- **Discussion of items to be added to the next scheduled meeting calendar**
 - Revised Map Development Process
 - December 15 items from proposed process
 - Changes to COI & Map Subcommittee
 - Physical Maps for the Public
- **Discussion and possible modifications to the meeting calendar**
 - None

Adjournment

Action: M/S/C (Nicol/Gallegos-Diaz) to adjourn the meeting.

Vote: Ayes - Cho, Choy, Cooper, Fox, Gallegos-Diaz, Hanson, Nicol, Rhodes, Smith, Sussell, Tran, Watson; Noes – None; Abstain – None; Absent – Alejos.

Adjourned at 9:04 p.m.

I hereby certify that the foregoing is a true and correct record of the Independent Redistricting Commission meeting held on December 1, 2021.

Mark Numainville
City Clerk

Communications

Communications submitted to the Independent Redistricting Commission are on file in the City Clerk Department at 2180 Milvia Street, 1st Floor, Berkeley, CA and are available upon request by contacting the City Clerk Department at (510) 981-6908 or redistricting@cityofberkeley.info or may be viewed through [Records Online](#).

Item #4: Review of Community of Interest Form Submissions

23. Josh Buswell-Charkow

Opinions on redistricting

24. Cai

Supplemental Communications

Item #3: Review of Community of Interest (COI) Form Submissions

25. Lynn Zamorra, Willard Neighborhood Association

Item #4: Review of Map Submissions

26. Commissioner Ronald Choy

General Comments

Neighborhoods

27. Carla Woodworth

28. Andrew Johnson, Bateman Neighborhood Association



No Material
Available for
this Item

There is no material for this item.

City Clerk Department
2180 Milvia Street
Berkeley, CA 94704
(510) 981-6900

The City of Berkeley Independent Redistricting Commission Webpage:
<https://www.cityofberkeley.info/irc/>



City Clerk Department

December 15, 2021

To: Independent Redistricting Commission
From: Mark Numainville, Commission Secretary
Subject: Redistricting Map Review and Development Process

This memo contains a revised version of the Map Development Process based on the Commission discussion at the December 1, 2021 meeting.

As noted in the previous memo, the period for public submission of redistricting maps ended on Monday, November 15, 2021 and a total of 29 maps were submitted for the Commission's consideration. The plans from the public provide valuable input to the Commission in the form of common themes and specific interests expressed, but they are not required to be the template from which the Commission determines the final boundaries. The ultimate discretion on final boundaries lies with the Commission.

The discussion of public maps and Community of Interest (COI) forms will continue through the end of 2021 and into January of 2022. The Commission will then transition into the map drafting phase and adoption of a final map in March 2022. All maps and COI forms are available online through the City's redistricting web page at cityofberkeley.info/redistricting.

Berkeley's Map Development Process

The Berkeley process is conducted primarily by City staff and the 13 members of the Commission. Commissioners selected from the community and experienced City staff have the best understanding of the legacy of Berkeley redistricting, Berkeley neighborhoods and Communities of Interest, and the physical features of the city that could impact district boundaries.

The process is linked to the regular meeting schedule adopted by the Commission. Additional special meetings may be added as needed to complete the analysis and map drawing. The timeline and process may be adjusted by the Commission as needed.

Currently, all Commission meetings are being held in a virtual-only setting pursuant to the ongoing state of emergency and the local findings made by the City Council. If health and safety conditions allow, the Commission could hold in-person meetings in 2022. Some potential venues for in-person meetings include UC Berkeley, South Berkeley Senior Center, Longfellow Middle School Auditorium, King Middle School Theater, and Live Oak Recreation Center. The Berkeley Unified School District Boardroom may be an option, however the dais was designed for nine people and would be somewhat crowded with 13 members. Staff will continue to monitor health and safety conditions and will continue preparing for in person meetings in the event that they are feasible.

The Map process will include additional opportunities for the public to review proposed maps both online and in person at locations such as Libraries and Senior Centers. Staff will continue to conduct outreach to the community and target specific organizations to try to solicit feedback and participation for key stakeholder groups.

Proposed Council District Map Review and Development Process

Wednesday, December 15, 2021 Regular Meeting (Virtual Only)

1. Map & COI Subcommittee presents the Map Matrix template with sample data included to facilitate discussion of the Matrix as a tool and make possible revisions to the template or analysis points (published in advance of the meeting).
2. Full Commission receives presentation on required criteria in City Charter and State Law.
3. Appoint Final Report Writing Subcommittee.

Monday, January 10, 2022 Regular Meeting (Virtual Only)

4. Map & COI Subcommittee submits completed Map Matrix and report on grouping of public maps with common themes for discussion. Themes may include Minor Change to Existing Districts; Significant Change to Existing Districts; West Berkeley (north-south or east-west boundary); North Berkeley (north-south or east-west boundary); Creation of a second “student district”; Northside in/out of “student district”; BART Stations; Neighborhood Boundaries.
5. Full Commission discusses and reviews public plans and analysis of required criteria – including COI forms received.
6. Full Commission provides direction to staff on the number of draft maps desired and significant map elements desired in the draft map options (elements from public maps, COI forms, public comments, commissioner research).
7. *Commission appoints two members to work with staff on the creation of the first set of draft IRC Maps.*
8. Federal Voting Rights Act information and analysis provided.

Thursday, January 27, 2022 Regular Meeting/Public Hearing #3 (In-Person or Virtual)

9. Staff presents multiple draft maps for commission and public review.
10. Full Commission receives community input on draft maps and provides direction to staff on any revisions.
11. Possible Commission action to narrow the number of draft maps under consideration.

Thursday, February 17, 2022 Regular Meeting/Public Hearing #4 (In-Person or Virtual)

12. Staff presents multiple draft maps for commission and public review.
13. Full Commission receives community input on draft maps and provides direction to staff on any revisions.
14. Possible Commission action to narrow the number of draft maps under consideration.

Date TBD – Special Public Meeting for public comment on Proposed Commission Map(s).

Monday, February 28, 2022 Regular Meeting/Public Hearing #5 (In-Person or Virtual)

15. Draft map(s) presented to Commission and the public for review and discussion.
16. Commission direction to staff on final single map for adoption.

Wednesday, March 16, 2022 Regular Meeting (In-Person or Virtual)

17. Commission adopts final map and report.

March 22 City Council Special Meeting

18. City Council adopts first reading of final map ordinance as approved by IRC pursuant to the City Charter.

April 12 City Council Regular Meeting

19. City Council adopts second reading of final map ordinance as approved by IRC pursuant to the City Charter.

Review of Required Redistricting Criteria

The required criteria for a compliant map are contained in the Fair Maps Act and the Berkeley City Charter. The criteria in the City Charter do not have a ranked priority, however, there are some criteria that have a “yes/no” answer while others have a subjective or comparative analysis. If a map cannot answer “yes” to both “yes/no” criteria, then it is not compliant with legal requirements. While the map should not be considered as a viable map, there may be specific elements or themes contained in that map that might be useful to consider. All the criteria are interrelated, and depending on the issues presented in the maps and the competing communities of interest, certain criteria may be prioritized over others in pursuit of the most compliant map possible.

The criteria in the Fair Maps Act do have a ranked priority, however, the Commission is not bound by those rankings because the Charter contains its own substantial criteria.

While the Commission is not bound by the state ranking, it may be informative in the evaluation process and is summarized below.

Election Code Section 21621(c)

The council shall adopt district boundaries using the following criteria as set forth in the following order of priority:

- 1) To the extent practicable, council districts shall be geographically contiguous.
- 2) To the extent practicable, the geographic integrity of any local neighborhood or local community of interest shall be respected in a manner that minimizes its division.
- 3) Council district boundaries should be easily identifiable and understandable by residents. To the extent practicable, council districts shall be bounded by natural and artificial barriers, by streets, or by the boundaries of the city.
- 4) To the extent practicable, and where it does not conflict with the preceding criteria in this subdivision, council districts shall be drawn to encourage geographical compactness in a manner that nearby areas of population are not bypassed in favor of more distant populations.

Yes/No Criteria

Nearly Equal Population: Acceptable difference between the smallest and largest district is no more 1,556 people or 10% of the equal district population number of 15,554. As an example, if the smallest district is 3% under the equal district population number, and the largest district is 4% over the equal district population number, the variance is 7%, which is within the allowable 10% threshold.

Contiguity: All parts of a district are connected to one another. There cannot be any “islands” – all parts of a district must be connected.

Comparative Criteria

Topography/Geography: Does the map account for significant topographical or geographic features? This usually refers to hills, valleys, ridges, open spaces, rivers, etc. It is not a disqualifying feature to cross a significant feature provided that it is justifiable under other criteria considerations.

Cohesiveness/Integrity: Do the district boundaries makes sense given the defined neighborhoods and communities of interests that have been identified? In this instance there may be more than one right answer as there may be competing communities of interest identified in overlapping or nearby areas.

Compactness: “You know it when you see it.” More technically defined as “not bypassing nearby populated areas in favor of more distant populated areas,” compactness refers to the shape of the district. A circle is the ultimate “compact” shape and shapes that have narrow or meandering arms or tentacles would be comparatively less compact.

Communities of Interest: Geographic integrity of a neighborhood or community of interest. A Community of Interest is a contiguous population that shares common social and economic interests that should be included within a single district for purposes of its effective and fair representation.

Such shared interests include but are not limited to those common to areas in which the people share similar living standards, use the same transportation facilities, have similar work opportunities, or have access to the same media of communication relevant to the election process, as well as neighborhoods, students, organized student housing, shared age, and racial demographics. Communities of Interest shall not include relationships with political parties, incumbents, or political candidates.

Easily Understood Boundaries/Major Traffic Arteries/Geography: The City Charter directs the Commission to use easily understood boundaries like major traffic arteries, but only to the extent that they are consistent with communities of interest.

Other City Charter Requirements

Political Considerations

The new Council Districts cannot be drawn for the purpose of favoring or discriminating against an incumbent, political candidate, or political party.

Use of Current Districts

The Commission is not required to use the existing boundaries as a starting point; however, the Commission may consider existing district boundaries as a basis for developing new district boundaries. If the map that the Commission adopts deviates substantially from the previous district boundaries in order to reflect population growth, protect communities of interest or better comply with the redistricting criteria in the City Charter, it must issue a report explaining its reasons for doing so.

Incumbent Councilmembers

The Commission shall not consider the residence of sitting Councilmembers. The residence address of the sitting Councilmembers has not been published or provided to the members of the Commission in any manner.

Preliminary Federal Voting Rights Act (FVRA) Analysis

The FVRA helps to ensure that there is no denial or abridgement of the right to vote on account of race, color, or membership in a language minority group. Council districts can be adjusted to help remedy such abridgement if the historical and demographic data provide adequate justification.

Preliminary analysis of Berkeley's demographics by the redistricting consultant appears to show that the demographics in Berkeley do not provide adequate populations to justify significant FVRA considerations and the creation of a majority minority district(s) in the

2020 map. Staff will consult with legal counsel to determine if a more comprehensive FVRA analysis is warranted.

City Charter Section 9.5(f) - Criteria for redistricting.

(1) The Commission shall adjust the boundaries of City Council districts in a manner that complies with the Constitution and statutes of the United States and the State of California, in order that the eight City Council districts shall be as nearly equal in population as may be according to the most recent decennial federal census, except where deviation is required to comply with the Federal Voting Rights Act.

(2) In establishing and modifying district boundaries, the Independent Redistricting Commission shall take into consideration topography, geography, cohesiveness, contiguity, integrity and compactness of territory of the districts, as well as existing communities of interest as defined below, and shall utilize easily understood district boundaries such as major traffic arteries and geographic boundaries to the extent they are consistent with communities of interest. The geographic integrity of a neighborhood or community of interest shall be respected to the extent possible without violating State or Federal law or the requirements of this Section. For purposes of this subsection "communities of interest" shall mean the following: A community of interest is a contiguous population which shares common social and economic interests that should be included within a single district for purposes of its effective and fair representation. Such shared interests include but are not limited to those common to areas in which the people share similar living standards, use the same transportation facilities, have similar work opportunities, or have access to the same media of communication relevant to the election process, as well as neighborhoods, students, organized student housing, shared age, and racial demographics. Communities of interest shall not include relationships with political parties, incumbents, or political candidates.

(3) Districts shall not be drawn for the purpose of favoring or discriminating against an incumbent, political candidate, or political party.

(4) The Independent Redistricting Commission may consider existing district boundaries as a basis for developing new district boundaries. Should the Commission deviate substantially in its redistricting plan from the previous district boundaries in order to reflect population growth, protect communities of interest or better comply with the redistricting criteria in the Charter, it shall issue a report explaining its reasons for doing so.

(5) The Independent Redistricting Commission shall not consider the residence of sitting Councilmembers.

(6) If the Independent Redistricting Commission adopts a redistricting plan that removes the residence of a sitting Councilmember from their then-current district, that Councilmember shall continue to serve on the City Council until the expiration of their term.

To: City of Berkeley Independent Redistricting Commission (IRC)
From: Communities of Interest (COI) / Map Review IRC Subcommittee
Date: December 15, 2021

Subject: COI Matrix and Draft Map Review Matrix

The COI / Map Review Subcommittee has met four times since December 1, 2021 with two - five members attending each meeting. All six subcommittee members were involved in these discussions.

COI Matrix

Attached is an updated COI matrix that includes information from the 56 submitted COI forms received as of November 29, 2021, as well as the three COI forms have been added since the December 1. The COI matrix summarizes COI feedback received in order to help evaluate submitted redistricting maps, help formulate draft IRC maps, and highlight the community concerns expressed to the IRC. Please review the contents to determine if further edits or corrections are needed to accurately utilize the submitted public feedback. Note that we have started to include public comments regarding COIs that are not submitted through the standard COI form, such as via email correspondence. We anticipate including more in the future.

Draft Map Review Matrix

The attached draft map review matrix has been prepared to help summarize and analyze the 29 submitted maps and accompanying narrative information received by the November 15, 2021 submittal deadline. The draft matrix includes columns to note the submitted maps alignment (or lack thereof) with the required City of Berkeley Charter considerations (e.g. Cohesiveness, Contiguity, Compactness, etc.) The draft map review matrix includes a column in which we have copied the narrative summary verbatim from the submitted map. The subcommittee has identified these narratives to be a key artifact in identifying the concerns of Berkeley residents. Further, the draft map review matrix includes the highest and lowest population variances by district in order to evaluate each submitted map's compliance with the maximum 10% population variance requirement. The subcommittee notes that submitted maps do not need to be compliant *per se* and a non-compliant map can provide useful insights to the desires of Berkeley residents, however we have found this metric to be informative as we evaluate each submitted map.

Importantly, we have included a column in which the IRC can summarize the theme of the submitted map. We see this as a useful data point to guide staff to develop a range of potential new maps to submit to the public.

Lastly, the draft matrix includes columns to summarize how the submitted maps are utilized by the IRC for developing draft redistricting maps for further public review.

Please review the draft matrix. Our goal is for this matrix to be an objective analytical tool which summarizes the major characteristics of submitted maps and highlight proposed changes to the existing City Council District Map. A sample of five maps has been initially evaluated using the draft matrix to highlight distinguishing map characteristics and identify major map themes. We will review these with the Commission to determine if the matrix can be finalized for the rest of the Commission to continue analyzing, or if the existing fields need to be edited further before distilling the data from each map into this format.

| # | Date Received | District | Submitted By | COI Summary | General Geographic Region | Approx Location for Map Pin | Approx Location Comments | COI Themes | Reference or Endorsement to Submitted Map? If Y, which one? | Is COI mappable? (Y/N) | Boundary Change Requested by Submitter (Y/N) | If YES, entire Commission will assess what considerations there are for applicable boundary/district changes | | |
|----|---------------|----------|------------------------------------|---|--|-----------------------------|--|--|---|------------------------|--|--|------------------------------------|-------|
| | | | | | | | | | | | | Boundary Change Recommended by Cx (Y/N) | Rationale for Recommendation by Cx | Notes |
| 1 | 7/19/2021 | 7 | Raina Zhao on behalf of ASUC | UC Berkeley student body | District 7, south of UC Berkeley campus. Most students live within 1 mile of campus. | 2490 Channing Way, 94704 | | STUDENT REPRESENTATION | | YES | STUDENTS SHOULD BE GROUPED TOGETHER | | | |
| 2 | 7/20/2021 | 2 | Joanna Louie | Infrastructure; crime; pollution | South west Berkeley | 2995 San Pablo Ave, 94702 | | NEIGHBORHOOD EQUITY; CRIME | | NO | | | | |
| 3 | 7/20/2021 | 5 | B. Yoder | Safety concerns | Ada Street between Ordway and Acton. Ada between Acton and Sacramento, folks on Acton and on Ordway from Hopkins to Rose, a few folks on Hopkins just below and just above Ordway. | 1400 Ada St, 94702 | | NEIGHBORHOOD COHESIVENESS; SAFETY | | YES | MAINTAIN COI | | | |
| 4 | 7/20/2021 | 5 | Margot Dashiel | Close proximity; neighborhood area | Ada street | 1400 Ada St, 94702 | | NEIGHBORHOOD COHESIVENESS | | YES | MAINTAIN COI | | | |
| 5 | 7/21/2021 | 5 | Joe Berry | Demographics; Development | Lower hills, near Marin/Arlington Circle. | 2100 Marin Ave, 94707 | | AFFORDABLE HOUSING; HOUSING EQUITY | | NO | | | | |
| 6 | 7/21/2021 | 5 | John | Gardening, art, music, food, being outdoors | Ada Street between Ordway and Acton. | 1400 Ada St, 94702 | | NEIGHBORHOOD COHESIVENESS | | YES | MAINTAIN NEIGHBORHOOD CONTIGUITY | | | |
| 7 | | 1 | Prateek Haldar | High quality schools, development at North Berkeley BART, affordable housing, creation of bike lanes, improving vibrancy of Hopkins/Gilman shopping/restaurants | Bound by Hopkins Street on the north, Sacramento on the west (or San Pablo) MLK on the east, and Cedar on the south. | 1359 Rose St, 94702 | | HOUSING EQUITY; HOUSING DEVELOPMENT; NO BERK BART | | NO | | | | |
| 8 | 7/28/2021 | 5 | 1546 Milvia | Gerrymandered out of District 4. Neighborhood/block split in 2 | Milvia at District 4/5 - split the 2 sides of the block and put in District 5 | 1450 Milvia St, 94709 | | COUNCILMEMBER RESIDENCY; NEIGHBORHOOD SPLIT | | YES | BOUNDARIES SHOULDN'T BE DRAWN BASED ON COUNCILMEMBER RESIDENCY | | | |
| 9 | 7/28/2021 | None | | Helping each other- sharing tools, offering rides, celebrating wins, informing each other about noisy construction, or house repairs | Tilden Park to the east and south, grizzly peak to the west and Cragmont to the north | 50 Whitaker Ave, 94708 | (Unclear geographic location. Selected Grizzly Peak Park address.) | NEIGHBORHOOD DESCRIPTION | | NO | | | | |
| 10 | 7/30/2021 | 8 | Vincent Casalaina | Crime reduction, maintaining characteristic housing (single-family or single family + ADU), transit | Willard neighborhood. Telegraph/Parker & College/Ashby. | 2730 Hillegass Ave, 94705 | | IMPROVED RESOURCE/SERVICE EQUITY; TRANSPORTATION; CRIME; SINGLE FAMILY HOUSING | | YES | | | | |
| 11 | 8/16/2021 | 5 | No name (kktompkins@gmail.com) | Beautification, Solano Ave corridor development, property crime | Far north Berkeley adjacent to Solano Ave to Albany border in the west. | 1559 Solano Ave, 94707 | | NEIGHBORHOOD DESCRIPTION; CRIME | | NO | | | | |
| 12 | 8/20/2021 | 2 | No name | Schools, garbage; effects from nearby homeless population | Fourth & Fifth, from Dwight to Addison | 800 Bancroft Way, 94710 | | NEIGHBORHOOD SAFETY; HOMELESSNESS | | NO | | | | |
| 13 | 8/26/2021 | None | No name | clean air, affordable low density housing, transportation networks that dont smash thru our neighborhoods, slow streets, public safety, litter and street trash, childcare, parks, trees, community green space | north west berkeley - west of San Pablo to University | 1529 Sixth St, 94710 | | NEIGHBORHOOD EQUITY/SERVICES; INDUSTRIAL ACTIVITY/ DEVELOPMENT/POLLUTION | | NO | | | | |
| 14 | 8/26/2021 | 1 | nan@essentialbusinessbehaviors.com | Families, safety, community | North Berkeley BART, Adult school on Virginia, Rose St. on other side of Cedar Rose Park, San Pablo Avenue, Cedar Street. | 1201 Virginia St, 94702 | | HOMELESSNESS; NORT BERK BART; HOUSING DENSITY | | NO | | | | |
| 15 | 9/12/2021 | 3 | No name | More racially mixed than North or Central Berkeley | Corner of Parker and McGee | 1700 Parker St, 94703 | | RACIAL DIVERSITY; PROPERTY VALUES | | NO | | | | |

| # | Date Received | District | Submitted By | COI Summary | General Geographic Region | Approx Location for Map Pin | Approx Location Comments | COI Themes | Reference or Endorsement to Submitted Map? If Y, which one? | Is COI mappable? (Y/N) | Boundary Change Requested by Submitter (Y/N) | If YES, entire Commission will assess what considerations there are for applicable boundary/district changes | | |
|----|---------------|----------|--------------|---|--|-----------------------------|--|--|---|------------------------|--|--|------------------------------------|--------------|
| | | | | | | | | | | | | Boundary Change Recommended by Cx (Y/N) | Rationale for Recommendation by Cx | Notes |
| 16 | 9/12/2021 | None | No name | International Coastal Clean-up month; Disaster Relief Committees; Food/beverage committee; Clean-up committee | B/W West Berkeley and North | 1720 Eighth St, 94710 | Changed it to James Kenney (Unclear geographic location. Picked an intersection in Northwest Berkeley neighborhood for pin.) | AFFORDABILITY; INCLUSION; WATERFRONT CLEAN-UP | | NO | | | | |
| 17 | 9/14/2021 | 6 | No name | Context (scale & mix), distant views, especially of the bay and the coastal hills; mainly a residential area with single-family homes, many with secondary units, typically with backyards and gardens; could see a mix of smaller vehicles and better transit, but it needs to be phased in, grandfathering older residents who depend on cars. Streets could be rethought. Filling every backyard with an ADU or building out single-family sites would be a mistake, but a thoughtful mix would be fine. Same comment about the Shattuck corridor - do't overload it. Some density but not a view-blocking wall. | Oxford Street and east. Odd situation where three districts overlap and near neighbors are represented by Hahn, Harrison, and Wengraf, whose districts differ substantially. District 6 should take in the north Shattuck corridor. We are closer to Thousand Oaks (Hahn) than the west side of Shattuck (Harrison) in interests, I sense. | 1600 Oxford St, 94709 | | HOME OWNERSHIP; VIEW PRESERVATION; DISTRICT BOUNDARIES (5&6); MAINTAIN SINGLE FAMILY HOUSING | | YES | MAINTAIN COI | | | |
| 18 | 9/23/2021 | 2 | Veronica | Latinos with long history of home ownership and multiple generation households | 5th street and San Pablo, between University and Dwight | 920 Allston Way, 94710 | | SERVICE ALLOCATION; RACIAL EQUITY; HISTORICAL LATINO NEIGHBORHOOD; RESOURCE EQUITY; MULTIGENERATIONAL LIVING | | NO | | | | |
| 19 | 9/27/2021 | 2 | Sheryl | public safety, education, beautification | San Pablo Park neighborhood, West Berkeley, Left Bank are all names used for D2 | 2501 San Pablo Ave, 94702 | | HOMELESSNESS; INDUSTRIAL POLLUTION; DIVERSITY; PUBLIC SAFETY | | NO | | | | |
| 20 | 9/28/2021 | 2 | Ms. Ty | Crime reduction, clean streets (eliminate illegal dumping), affordable housing | South Berkeley | 3100 Adeline St, 94703 | (Unclear geographic location. Selected park near Sacramento and Fairview.) | FORGOTTEN NEIGHBORHOOD; ILLEGAL DUMPING; CRIME; AFFORDABLE HOUSING | | NO | | | | |
| 21 | 9/28/2021 | 3 | Ayanna Davis | Berkeley Black Community, State of Black Berkeley | My community of interest is South West Berkeley beginning at Cedar and 4th Street and ending at 62nd and Adeline. West Berkeley, South Berkeley, Loren District | 2546 Tenth St, 94710 | (Large geographic location. Selected an address central to the described area.) | HOUSING/RESOURCE EQUITY; POVERTY; FOOD INSECURITY; HEALTH/ECONOMIC EQUITY; HISTORICAL BLACK NEIGHBORHOOD | | YES | No, MAINTAIN DISTRICT 3 | | | UNDERFUNDED? |
| 22 | 9/29/2021 | 1 | James | Public safety (homelessness/mentally ill people) | Gourmet Ghetto | 1549 Shattuck Ave, 94709 | (Unclear geographic area. Selected address in North Shattuck neighborhood.) | PUBLIC SAFETY; HOMELESSNESS; MENTAL ILLNESS | | NO | | | | |
| 23 | 9/29/2021 | 3 | No name | diversity in ppl and architecture. nice flat and walkable, close to SF, Oakland, easy access; | South Berkeley | 3075 Adeline St, 94703 | (Unclear geographic area. Selected address near streets named in COI form.) | HOMELESSNESS; CRIME; ECONOMIC DEVELOPMENT; RESOURCE EQUITY; DIVERSITY | | NO | | | | |
| 24 | 10/2/2021 | 4 | No name | Safe neighborhood (walkable/bike friendly); traffic concerns, homelessness/littering, UC Berkeley take over of town. | Central Berkeley between Sacramento and downtown. | 2246 McGee Ave, 94703 | | PUBLIC SAFETY; TRANSPORTATION SAFETY; HOMELESSNESS; RELATIONSHIP WITH UCB | | NO | | | | |

| # | Date Received | District | Submitted By | COI Summary | General Geographic Region | Approx Location for Map Pin | Approx Location Comments | COI Themes | Reference or Endorsement to Submitted Map? If Y, which one? | Is COI mappable? (Y/N) | Boundary Change Requested by Submitter (Y/N) | If YES, entire Commission will assess what considerations there are for applicable boundary/district changes | | | |
|----|---------------|----------|------------------|--|---|-----------------------------|---|---|---|------------------------|--|--|------------------------------------|-------|------------|
| | | | | | | | | | | | | Boundary Change Recommended by Cx (Y/N) | Rationale for Recommendation by Cx | Notes | |
| 25 | 10/8/2021 | 5 | north Shattuck | Environment, trees, city upkeep, art, ease of shopping, parking, good food, lovely parks, socializing, access to BART. | Marin Circle to University Avenue, from Grizzly Peak to Sacramento streets. Name provided: North Shattuck | 1444 Shattuck Pl, 94709 | Changed the pin to the Safeway in North Berkeley | TRANSPORTATION; FIRE SAFETY/EVACUATION; ROADWAY CONDITIONS; HOMELESSNESS | | YES | | | | | DISTRICT 5 |
| 26 | 10/16/2021 | 8 | Elizabeth | | Elmwood District | 2703 Stuart Street, 94705 | | None | | See map | See map | | | | MAP |
| 27 | 10/16/2021 | 2 | Ben Gardella | Strawberry Creek Park | Alston, Sacramento, Sacramento and Dwight Street Name provided: Poet's Corner | 1314 Bancroft Way, 94702 | | MAINTAIN COI; NEIGHBORHOOD CONTIGUITY; PARK | | YES | MAINTAIN DISTRICT | | | | |
| 28 | 10/16/2021 | 2 | Heather Clauge | Strawberry Creek Park | University to Dwight, Sacramento to San Pablo Name provided: Poet's Corner | 1298 Bancroft Way, 94702 | | PARK/RECREATION; HOMELESSNESS; COI NEIGHBORHOOD CONTIGUITY | | YES | MAINTAIN DISTRICT | | | | |
| 29 | 10/17/2021 | 2 | Douglas Smith | Families raising young children, retirees and elders aging in place, multigenerational housing--all of whom patronize the businesses along the San Pablo and University corridors and make use of primary parks like San Pablo Park, Strawberry Creek Park & Aquatic Park. Neighbors band together to monitor safety & crime, pedestrian/bike safety, working closely with our new Councilmember Taplin. There is a cohesive atmosphere which underscores a sense of this being a true community of individuals, looking out for each other. | South to San Pablo Park, the 9th Street Bike Boulevard to the west, north to University Avenue, and east to Sacramento Street. University Avenue does seem to be a true dividing line and an appropriate boundary between D2 and D1; somehow San Pablo does not divide the Community. Name provided: Poet's Corner | 1312 Bancroft Way, 94702 | | MULTIGENERATIONAL HOUSING; PARKS & RECREATION; SAFETY; CRIME | | YES | MAINTAIN DISTRICT | | | | |
| 30 | 10/17/2021 | 1 | No name | Preserving residential character of neighborhood for livability. Safety of residents (crime prevention and optimal traffic/pedestrian flow). Diverse demographics. | San Pablo to the west, University Avenue to the South; Shattuck to the East; and Vine to the north. Name provided: Northbrae | 1619 Edith St, 94703 | | TRAFFIC/TRANSPORTATION SAFETY; POPULATION DENSITY; NEIGHBORHOOD LIVABILITY; ZONING; INADEQUATE REPRESENTATION | | YES | PRESERVE RESIDENTIAL CHARACTER | | | | |
| 31 | 10/18/2021 | 2 | No name | commitment to Family, school, community events, shared political affiliations, diverse cultures, mixed low and middle income housing and proximity to shopping. We enjoy our Great walking and biking score! | From the Bay to Sacramento Street; from University to Bancroft. Connected to neighbors, particularly on Byron Street and Cowper. Name provided: Poet's Corner | 2228 San Pablo Ave, 94702 | | TRAFFIC CONTROL; STREET PAVING; DENSITY; ECONOMIC DEV; FERRY; MIXED HOUSING | | YES | MAINTAIN DISTRICT | | | | |
| 32 | 10/18/2021 | 2 | Ariel Smith-Iyer | Appreciation for diversity; common interest in continuing to be a place for all in the neighborhood. Strawberry Creek Park is an important community meeting place; area surrounding the park, Corp Yard, and bowling green vacant lot should remain together to collectively decide the future of the space. | San Pablo to Sacramento; University Avenue to Dwight Way. Name provided: Poet's Corner | 1302 Bancroft Way, 94702 | | TRASH COLLECTION; PARKS & RECREATION; OVER POPULATION; ECONOMIC DEVELOPMENT; DIVERSITY | | YES | MAINTAIN DISTRICT | | | | |
| 33 | 10/18/2021 | 2 | No name | Traffic and speeding | West Berk Flat Lands between Sacramento & San Pablo. | 2500 Bonar St, 94702 | Incomplete boundaries; selected address at intersection of Dwight Way & Bonar Street. | TRANSPORTATION SAFETY; SERVICE ALLOCATION; TRAFFIC SAFETY | | NO | | | | | |

| # | Date Received | District | Submitted By | COI Summary | General Geographic Region | Approx Location for Map Pin | Approx Location Comments | COI Themes | Reference or Endorsement to Submitted Map? If Y, which one? | Is COI mappable? (Y/N) | Boundary Change Requested by Submitter (Y/N) | If YES, entire Commission will assess what considerations there are for applicable boundary/district changes | | Notes |
|----|---------------|----------|--------------|---|--|------------------------------|---|--|---|------------------------|--|--|------------------------------------|-------|
| | | | | | | | | | | | | Boundary Change Recommended by Cx (Y/N) | Rationale for Recommendation by Cx | |
| 34 | 10/26/2021 | | No name | Communities of interest that previous cycles of redistricting have dismissed: 1. Prospect Street is a community of interest currently split between District 7 and District 8. The east side of Prospect is in District 8, and the west side is in District 7. Both sides of the street should be in the same district. Both sides of Prospect Street have more in common with Southside than with Panoramic Hill or Elmwood-Claremont. 7. Clark Kerr Campus is in District 8. The students who live there have more in common with Southside than with Elmwood-Claremont. 8. Redwood Gardens, a senior housing facility located on the Clark Kerr Campus, has more in common with Elmwood-Claremont neighbors than with students and should be considered a community of interest separate from students' community of interest. 9. Faculty housing on Clark Kerr Campus is a community of interest that has more in common with Elmwood-Claremont than with students. 10. The blocks within Dwight-Waring-Derby-Telegraph have more in common with Southside than with Elmwood-Claremont. 11. I House and the student co-ops behind it are in District 8. The residents of these dorms have more in common with Southside than with Elmwood-Claremont. 12. The blocks within Cedar-Oxford-Hearst-Arch are part of Northside and not split between District 5 and District 6. Northside should extend to Walnut, maybe even Shattuck. 13. The blocks within Sacramento-Ashby-California-border are in District 2. They should be in District 3. 14. The blocks within University-Acton-Allston-Sacramento are part of Poet's Corner, which is in District 2. 15. | | 2180 Milvia Street, 94704 | Not specific to one address or area; used Civic Center address as a general location, | None | | See map | See map | | | MAP |
| 35 | 11/3/2021 | 1 | Phil Allen | By the looks of things in my part of D-1, this is a townish and family (dwellings) area of the city. I see family activity and the retail and recreational which sustain them. There is no overt presence of UC students; they seem to be elsewhere. Retired friends gather here, internet junkies there. San Pablo Avenue provides a traditionally gritty 'home' to a constant presence of lost and forgotten citizen/ghosts and their movable social spots. | My 'felt' boundaries, running from close-by San Pablo/Delaware as center, are: Addison (south); 9th St. (west); Gilman (north), indeterminate (east). Names provided: Cutthroat Corner or Almost Oceanview | 1740 San Pablo Avenue, 94702 | Incomplete boundaries; selected intersection of San Pablo/Delaware. | RETURN TO PAST; HOMELESSNESS; MENTAL ILLNESS; ECONOMIC DEVELOPMENT; FORGOTTEN CITIZENS | | NO | | | | |

| # | Date Received | District | Submitted By | COI Summary | General Geographic Region | Approx Location for Map Pin | Approx Location Comments | COI Themes | Reference or Endorsement to Submitted Map? If Y, which one? | Is COI mappable? (Y/N) | Boundary Change Requested by Submitter (Y/N) | If YES, entire Commission will assess what considerations there are for applicable boundary/district changes | | |
|----|---------------|----------|-------------------|---|---|-----------------------------|---|--|---|------------------------|--|--|------------------------------------|-------|
| | | | | | | | | | | | | Boundary Change Recommended by Cx (Y/N) | Rationale for Recommendation by Cx | Notes |
| 36 | 11/6/2021 | 5 | Barbara Ann Yoder | I am part of a vibrant neighborhood group established probably in the 1980s, when former fire chief Bill Brock and his wife initiated annual gatherings during National Night Out. For the last 13 years since I moved to Ada Street, our neighborhood group has worked together sharing safety concerns and looking out for each other. We currently have 65 households in our group. We are in touch via email. We meet annually. We know each other by name. We have a neighborhood earthquake cache and a neighbor on Ordway offers trainings. All of Ada Street below Sacramento should be in District 1, where we used to be. When the lines were redrawn, they went right down the middle of our street. As a neighborhood we are impacted by development plans at N. Berkeley BART, Ruth Acty School traffic and events, Cedar-Rose Park events, traffic on Hopkins and the Ohlone Greenway—all in District 1. We should be rejoined with District 1. | Our neighborhood group currently includes 65 homes along Ada Street from Ordway to Acton and about halfway up the next block toward Sacramento. It includes most homes on Ordway from Hopkins to Rose, several homes on Rose and on Hopkins that back to Ada between Ordway and Acton, and most homes on Acton from Hopkins to Ada. Everyone in these blocks are welcome in our group. When you redraw the lines, if a street needs to be split down the middle, it shouldn't be a quiet short street like Ada; it should be a busy through street with double yellow lines, like Hopkins from Ordway to Acton. Also, if Ordway between Hopkins and Ada is split down the middle, it too should be reincorporated into District 1. | 1400 Ada St, 94702 | Appended to COI Form #3 (submitter's first COI form) | NEIGHBORHOOD CONTINUITY; TRAFFIC SAFETY; BART; RESIDENTIAL CHARACTER | | YES | REJOIN ADA ST TO DISTRICT 1 | | | |
| 37 | 11/8/2021 | 3 | Carl McPherson | Students & Renters | There is considerable overlap between renters and students, and we are concentrated in the areas around Berkeley main campus and the two BART stations. As I look at the maps already submitted, I think that Alfred Twu's "Compact Donut" map does a good job of collecting the main student populations into 2 districts on the southside and the areas just west and north of the main campus. It's unfortunate that we don't have 9 districts to work with, as I think—for population balancing purposes—Alfred Twu's map is unable to extend far enough North-South along the Shattuck corridor or far enough south on the Telegraph corridor to create 3 renter/student districts (Southside, Northside and "Westside"). Stephen Young's excellent map (which has several nice innovations, including taking the hillier parts of current Districts 5 and 6 and combining them into a single district) creates a district for the | 1947 Center Street, 94704 | (Unclear geographic boundaries; selected 1947 Center Street as central location). | ADD ANOTHER STUDENT DISTRICT; UP-ZONING (HOUSING DIVERSITY); PUBLIC TRANSPORTATION | | YES | STUDENT REPRESENTATION | | | |

| # | Date Received | District | Submitted By | COI Summary | General Geographic Region | Approx Location for Map Pin | Approx Location Comments | COI Themes | Reference or Endorsement to Submitted Map? If Y, which one? | Is COI mappable? (Y/N) | Boundary Change Requested by Submitter (Y/N) | If YES, entire Commission will assess what considerations there are for applicable boundary/district changes | | |
|----|---------------|----------|-----------------|---|--|-----------------------------|------------------------------------|--|---|------------------------|--|--|------------------------------------|------------------|
| | | | | | | | | | | | | Boundary Change Recommended by Cx (Y/N) | Rationale for Recommendation by Cx | Notes |
| 38 | 11/8/2021 | 4 | David Ushijima | The community in this neighborhood is tied together not only by our geographical proximity and walkability of the neighborhood but our shared interest in many activities that are within walking distance in the nearby Downtown and Theatre districts. Also because of our close proximity to the University, we also share the common interests of cultural and intellectual events held on the UC Berkeley campus. | Dwight Way (south), University Avenue (north); MLK (east), Sacramento (west). Name provided: Spaulding-McGee tract. Please do not break up this community by drawing lines which would bisect the natural geographic boundaries of this community. | 1700 Bancroft Way, 94703 | | CULTURAL ACCESS; RELATIONSHIP WITH UC B | | YES | NEIGHBORHOOD CONTIGUITY DIST 4 | | | |
| 39 | 11/12/2021 | 4 | Stephanie Allan | As a resident of the Flatlands since 1969, I have a strong interest in how District 4 is drawn or redrawn. When I first moved here, the neighborhood bounded by Shattuck/University/Sacramento/Dwight Way was primarily a working class area, predominantly white, but with some black families on Jefferson and Spaulding. It was a fairly tight community, located between the student/University area to the east, the historic black community to the west. There were lots of families here and a lot of kids. My son grew up & went to Washington school in this area. I worked hard to build a lot on Roosevelt and get a barrier at Channing & Roosevelt as well as a stop sign on McGee. (Pedestrian safety is still a major worry here, though) The housing used to be affordable. No longer, of course, like the rest of Berkeley. My neighborhood on Channing Way has been affected by the homeless crisis. Because we have a free box on Channing, between Roosevelt & McGee, we get a lot of homeless traffic from Downtown. Also, until we, reluctantly, agreed to have parking restrictions, the streets were jammed with UC students' parking. We supported making Channing Way a bike street although the condition of the road makes biking hazardous. The park area on the Ohlone strip was a great addition to the area. Aside from the park at Washington (where I participated in the redesign and addition of a regulation size basketball court when I was chair of the remodel committee) and the Tot Lot on Roosevelt, there isn't a lot of open space in our neighborhood. Civic Center Park was for so many years not a hospitable space. There is still a great deal of drug dealing going on there, probably migrating down from Shattuck. While much has changed, a lot hasn't. There's still a strong culture of neighborhoodness and cooperation. A lot of | University/Shattuck/Dwight Way/Sacramento Name provided: The Flatlands | 1712 Channing Way, 94703 | | TRANSPORTATION SAFETY; PARKS & RECREATION; CRIME | | YES | NEIGHBORHOOD CONTIGUITY DIST 4 | | | |
| 40 | 11/13/2021 | 2 | No name | Strawberry Creek Park brings our neighbors together - park should be in one district with all of its surrounds. | Strawberry Creek | 1260 Allston Way, 94702 | Strawberry Creek address | STRAWBERRY PARK IN ONE DISTRICT; NEIGHBORHOOD CONTIGUITY | | YES | NEIGHBORHOOD CONTIGUITY DIST 2 | | | |
| 41 | 11/14/2021 | 2 | No name | Culture, history, community - preservation of those. Black Repertory Group has been a vital part of that for almost 60 years. Redistricting such that would exclude Black Repertory Group from district 2 will mean that Black Repertory group and the commitment BRG has to district 2 and the community has to BRG are not being recognized or considered. please keep Black Repertory Group in district 2 | South Berkeley, Adeline Corridor Name provided: District 2 | 3201 Adeline St, 94703 | Used Black Repertory Group address | BLACK CULTURAL COHESIVENESS/HISTORY | | YES | MAINTAIN DISTRICT | | | DISTRICT 2 OR 3? |

| | | | | | | | | | | | | | If YES, entire Commission will assess what considerations there are for applicable boundary/district changes | |
|----|---------------|----------|--------------|---|---|-----------------------------|--|--|---|------------------------|--|---|--|------------------|
| # | Date Received | District | Submitted By | COI Summary | General Geographic Region | Approx Location for Map Pin | Approx Location Comments | COI Themes | Reference or Endorsement to Submitted Map? If Y, which one? | Is COI mappable? (Y/N) | Boundary Change Requested by Submitter (Y/N) | Boundary Change Recommended by Cx (Y/N) | Rationale for Recommendation by Cx | Notes |
| 42 | 11/14/2021 | 2 | Monika Scott | I live and work in the Lorin District. The Lorin District 2 is historical African American community. I would like the community to remain unchanged and that Black Reperatory Group remain in the district. | The Lorin / District 2 | 3215 Adeline St, 94703 | Address next to the Black Repertory Group | CULTURAL COHESIVENESS; MAINTAIN HISTORICAL BLACK COMMUNITIES; LORIN DISTRICT | | YES | MAINTAIN DISTRICT | | | DISTRICT 2 OR 3? |
| 43 | 11/15/2021 | 3 | No name | <p>Protect neighborhood resources of light, air, space, open areas, common spaces. Help neighbors and be vigilant for diverse communities who have been marginalized/victimimized - particularly Muslim people, Asians and African Americans who reside in our immediate neighborhood. We live near/adjacent to Shattuck, with lots of traffic in and out of Berkeley and so we keep an eye out for each other.</p> <p>Socializing in the neighborhood is important - especially since the pandemic. Our door gatherings are now a thing. Watching our for children and making sure that traffic - vehicular and pedestrian- respect the ability of children to run around and play outside in a positive environment. Solar access for gardens and solar panels is a concern in our neighborhood in every house. Our western sky/space is especially important for the sunlight, air and views. The area is densely populated with small houses, apartments, coop houses and group living. With this density and close proximity people are very respectful.</p> | Walker Street has become our gathering spot - that runs between Derby and Ward that runs from Shattuck on the West to east of Fulton. We also have gatherings on Fulton with the blocks running East up towards Telegraph. Walker Street is a frequent name for our neighborhood. | 2655 Shattuck Ave, 94704 | Used intersection of Walker Street and Shattuck Avenue | NEIGHBORHOOD RESOURCES; TRANSPORTATION SAFETY; MARGINALIZED COMMUNITY; RESOURCE EQUITY | | YES | MAINTAIN DISTRICT | | | |

| # | Date Received | District | Submitted By | COI Summary | General Geographic Region | Approx Location for Map Pin | Approx Location Comments | COI Themes | Reference or Endorsement to Submitted Map? If Y, which one? | Is COI mappable? (Y/N) | Boundary Change Requested by Submitter (Y/N) | If YES, entire Commission will assess what considerations there are for applicable boundary/district changes | | |
|----|---------------|----------|--------------|---|---|--|--|--|---|------------------------|--|--|------------------------------------|--------------------------------|
| | | | | | | | | | | | | Boundary Change Recommended by Cx (Y/N) | Rationale for Recommendation by Cx | Notes |
| 44 | 11/14/2021 | 3 | C. Hutching | <p>Many African Americans (AA) moved to South Berkeley during WW2 to support the war effort. They were restricted from living in other parts of Berkeley due to redlining laws. Together, with other newcomers from Asia and Central America, they shaped the neighborhood into a thriving community which reflected their cultural, artistic, religious and political beliefs. Key tenets of our historical neighborhood are shared by my community members today. Those beliefs include, but are not limited to, respecting the civil rights for every citizen, housing rights for all, rights to jobs and a right to worship.</p> <p>The faith community is actively engaged in supporting the values upheld by my community and is represented with churches scattered around South Berkeley. For example, The Church by The Side of the Road located east of Shattuck on Russell St. is leading a consortium of church leaders in the mentoring of young people. The Ephesian Church, with the active support of community groups in this area, is committed to building low/low-income housing on its site. The Buddhist Temple on Russell is also engaged in service in the community and is a welcoming place to families and neighbors for outdoor weekend lunches.</p> <p>There are many places of interest and programs serving my community like Kiwi</p> | <p>This area is known as South Berkeley. The current geographic location is Dwight Way on the North, Ellsworth on the East, 62nd on the South and Sacramento and California on South.</p> <p>The eastern swath of this area (from Dwight on the North going south on Ellsworth to Ashby and moving slightly westward at Deakin) should remain intact to represent the shared interests (stated above) of this community.</p> <p>Additionally, the southern swath of this District (going from Dwight on the North to 62nd on the South) is instrumental in reflecting the common shared interests of our community.</p> <p>Based on the maps that have been submitted to date, Howard Rosenberg's map looks the closest</p> | 1730 Oregon St, 94703 | Used Grove Park address | <p>BLACK CULTURAL COHESIVENESS; FAITH COMMUNITY; TRANSPORTATION; MAINTAIN HISTORICALLY BLACK NEIGHBORHOOD; PUBLIC SAFETY; INDUSTRIAL POLLUTION</p> | | YES | MAINTAIN DISTRICT | | | REFERENCE HOWARD ROSENBERG MAP |
| 45 | 11/14/2021 | 1 | Meryl Siegal | <p>There are several common interests in our community: we are a transit oriented community bounded by BART, AC Transit and cars looking for parking once BART depletes the number of spaces. It makes sense to sever the district at Sacramento Street since the communities East of Sacramento do not have the same interests, development and history as the communities West of Sacramento. It is a community of interest because it has a major street that runs all the way to the hills and down to the Bay, East to West. It is a community of interest because it includes a highway as a street (San Pablo Ave). Furthermore, the community is also one that experiences toxic fumes from industrial corporate concerns. Finally, it is a community of interest because several of the houses are still owned by people of color who were not allowed to buy homes east of Sacramento.</p> <p>The community houses several families. It really is a community about families, schools and play grounds. The community is a conduit for evacuation from the hills if</p> | <p>Geographically it is a community of interest because it includes the Berkeley Marina district and so should expand past University (not stop there as it does now). Geographically, the community is flat and down hill from the rest of Berkeley. The community is also an international community from the Brazilian cultural center, to Spanish table, to the Halal restaurants, our community is international and cosmopolitan.</p> | 1529 San Pablo Ave, Berkeley, CA 94702 | Used address central to current District 1 (intersection of San Pablo and Cedar) | <p>TRANSPORTATION; INDUSTRIAL/ENVIRONMENTAL POLLUTION</p> | | YES | EXPAND DISTRICT | | | BNC REDISTRICTING MAP |

| # | Date Received | District | Submitted By | COI Summary | General Geographic Region | Approx Location for Map Pin | Approx Location Comments | COI Themes | Reference or Endorsement to Submitted Map? If Y, which one? | Is COI mappable? (Y/N) | Boundary Change Requested by Submitter (Y/N) | If YES, entire Commission will assess what considerations there are for applicable boundary/district changes | | |
|----|---------------|----------|--------------|---|--|-----------------------------|--|--|---|------------------------|--|--|------------------------------------|---------------|
| | | | | | | | | | | | | Boundary Change Recommended by Cx (Y/N) | Rationale for Recommendation by Cx | Notes |
| 46 | 11/15/2021 | 7 | No name | Renters; pedestrians, cyclists, and transit riders; students. | This is concentrated in the areas with a high density of renters, including Downtown, southside blocks south of the current District 7, Clark Kerr campus, and "northside" up to Virginia Street The renter community is overwhelmed in the current districting by being split among districts dominated by homeowners. Renters vote less frequently than homeowners as a community and are therefore further drowned out. We need an additional district that protects and represents the significant number of renters in the City, such as the donut district on the map proposed by Alfred Twu, one draft example attached. | 2355 Telegraph Ave, 94704 | Incomplete boundaries provided; selected address at Durant/Telegraph | RENTERS/STUDENT COMMUNITY; TRANSPORTATION SAFETY; HOMELESSNESS | | YES | ADD NEW DISTRICT | | | MAP ATTACHED |
| 47 | 11/15/2021 | 4 | Ben Gould | 1. Housing affordability; 2. Bike/pedestrian/transit access & safety; 3. Homelessness Downtown Berkeley is an incredibly diverse community of over 6,000 residents, 95% of whom are renters. Downtown is comprised of students, young professionals, immigrants, families, retirees, and long-time residents alike, including both housed and unhoused neighbors. Downtown has been historically considered "everyone's neighborhood" because of the diverse commercial and leisure activities and the access to transit and major institutions (UC Berkeley, LBNL, City of Berkeley). However, for the thousands of people who call Downtown home on a daily basis, it is also a residential community, where we need to be able to get home safely and comfortably at night, have non-automotive transportation options that make it easy to get to our destinations, and have enough housing options and tenant protections to keep rent affordable. City Council has historically neglected the residential experience in Downtown Berkeley. Downtown Berkeley is most similar to the mixed-use and medium density neighborhoods immediately north and south along Shattuck Avenue. Because the most unifying experience of living in Downtown is "renters who don't have cars", other neighborhoods with high concentrations of renters who don't have cars are particularly good matches for joining into a Council district. Other campus periphery areas, such | Hearst to the north; Oxford/Fulton to the east; Dwight to the south; MLK to the west. Name provided: Downtown Berkeley | 2272 Shattuck Ave, 94704 | | TRANSPORTATION SAFETY; HOMELESSNESS; HOUSING AFFORDABILITY; TRANSIT ACCESS; TRANSPORTATION; RENTER/ STUDENT REPRESENTATION | | YES | ADD NEW RENTER/STUDENT DISTRICT | | | ALFRED TWU MA |

| # | Date Received | District | Submitted By | COI Summary | General Geographic Region | Approx Location for Map Pin | Approx Location Comments | COI Themes | Reference or Endorsement to Submitted Map? If Y, which one? | Is COI mappable? (Y/N) | Boundary Change Requested by Submitter (Y/N) | If YES, entire Commission will assess what considerations there are for applicable boundary/district changes | | |
|----|---------------|----------|------------------------------|---|---|-----------------------------|------------------------------------|---|---|------------------------|--|--|------------------------------------|--------------|
| | | | | | | | | | | | | Boundary Change Recommended by Cx (Y/N) | Rationale for Recommendation by Cx | Notes |
| 48 | 11/15/2021 | 3 | Berkeley Branch of the NAACP | <p>Berkeley's Black community; churches, businesses, homeowners and tenants in primarily South Berkeley's area which now falls into "District 3." History and ancestors in common; many of us moved in the migration west from the Deep South after slavery and Jim Crow, many of us share a deep and abiding faith in God (Black Christian Churches are historic pillars of the city for a hundred years: Church by the Side of the Road, McGee Ave Baptist Church, St. Paul's AME Church, Ephesians Church, Phillips AME, etc).</p> <p>Black academics, artists and activists are a core part of our community; housing should be available to ensure Black members thrive in our historic district that should be deemed the Black Community Historical Zone. The Adeline Corridor and So Berkeley needs to not be further displaced or diluted. Berkeley NAACP, BEEMA and other Black organizations in Berkeley strongly urge that District 3 remain without alteration. Specifically: McGee Ave Baptist Church should not be placed into District, 2, nor should Church by Side of Road be drawn</p> | Current District 3 | 1730 Oregon St, 94703 | Used Grove Park address for pin | HISTORICAL BLACK/MUSLIM NEIGHBORHOOD; FAITH BASED COMMUNITY; ACCESS | | YES | MAINTAIN DISTRICT 3 | | | MAP ATTACHED |
| 49 | 11/15/2021 | 1 | No name | <p>Working-class neighborhood, which includes many Craftsman-style homes (and a few Victorians), built by blue-collar workers for their families. It also retains a - albeit diminishing - level of racial and socioeconomic diversity as one of the only neighborhood in which restrictive covenants were not placed on housing (as a formerly redlined area). This area bounds the MU-R and MU-LI areas, and neighborhoods have striven to coexist with industry that would now be deemed to be incompatible with residential - and has embraced the ecosystem of small manufacturing, arts, and crafts businesses, some of whose owners reside in live-work units in the neighborhood.</p> | <p>The Oceanview District is roughly bounded by San Pablo on the East Side, the waterfront on the West Side, Gilman St. on the North Side, and University Ave. on the South Side. However, our community arguably has more in common with the entire area below San Pablo than other neighborhoods. We certainly have more in common with other areas below Sacramento (roughly bounded by the North Berkeley BART) than areas to the east of Sacramento.</p> <p>Name provided: Oceanview District</p> <p>For your consideration, a West Berkeley Business District oriented map proposal has been created (most districts except 2 are within less than 1% of the threshold for compactness, the least compact district is D6 and it's within 3.6%).</p> | 1720 Eighth St, 94710 | Used James Kenney Community Center | SINGLE FAMILY ZONING; LOCAL/SMALL BUSINESSES; WORKING CLASS NEIGHBORHOOD; HOUSING DENSITY; MANUFACTURING/ARTS & CRAFTS; LIVE/WORK UNITS; LIGHT INDUSTRIAL; COMMON CULTURE | | YES | MAINTAIN OCEANVIEW DISTRICT | | | MAP ATTACHED |

| # | Date Received | District | Submitted By | COI Summary | General Geographic Region | Approx Location for Map Pin | Approx Location Comments | COI Themes | Reference or Endorsement to Submitted Map? If Y, which one? | Is COI mappable? (Y/N) | Boundary Change Requested by Submitter (Y/N) | If YES, entire Commission will assess what considerations there are for applicable boundary/district changes | | |
|----|---------------|----------|--|--|--|-----------------------------|--|--|---|------------------------|--|--|------------------------------------|--------------|
| | | | | | | | | | | | | Boundary Change Recommended by Cx (Y/N) | Rationale for Recommendation by Cx | Notes |
| 50 | 11/15/2021 | 4 | Wendy Aifsen & Nancy Holland | Geographic, historical, economic, cultural, and racial/ethnic diversity interests; common interests in quiet with less noise, less litter, less flooding, less air pollution, fewer vehicles, improved traffic safety, reduction of danger from cut-through & commute traffic; religious centers. | See map attachment to COI form Name provided: Greater Flatlands | 1607 Bancroft Way, 94703 | Used intersection of McGee Avenue & Bancroft Way. | MAJOR TRAFFIC ARTERY; TRANSPORTATION SAFETY; DENSITY; TRAFFIC | | YES | RECONFIGURE DISTRICT | | | MAP INCLUDED |
| 51 | 11/16/2021 | 3 | No name | Sun, air, and space are resources we want to protect. We have just enough space, and we get along well and watch out for each other. This is important because we have small children, senior citizens and members of marginalized communities that have seen a lot of hatred: Muslims, Asian, and African American. We keep an eye out for our neighbors and have a history of showing up, in person to take care of mutual concerns. We love the sound of children playing outside, and during the pandemic our outside space on Walker Street became the focus of neighborhood outdoor gatherings. These gatherings were about the only "socializing" any of us did for a year. | Shattuck to the west. Comprises Derby and Ward all the way past Fulton. Name provided: Walker Street / Le Conte | 2108 Derby St, 94705 | Used intersection of Derby Street & Walker Street. | INADEQUATE REPRESENTATION; HOUSING DENSITY; HOMELESSNESS; ECONOMIC/RACIAL DIVERSITY | | YES | KEEP NEIGHBORHOOD BOUNDARIES-DISTRICT 3 | | | |
| 52 | 11/16/2021 | 1 | Afi Kambon for Berkeley Visionary Equity Summit Alliance | Historically Black community. A place of inclusion, tolerance, and caring; youth and elders connecting; affordable housing and a fair and inclusive approach to development that benefits low-income residents including a right of return for those displaced or unhoused, and safe community policing. | Maintain current District 1 boundaries; at least as far east as Sacramento Street, the former "color line." | 1531 San Pablo Ave, 94702 | Intersection of Cedar & San Pablo. | HISTORICAL BLACK NEIGHBORHOOD; AFFORDABLE HOUSING; LOW INCOME RESIDENCE; INADEQUATE REPRESENTATION; SENIOR RESOURCE EQUITY; CRIME/POLICING | | YES | KEEP BOUNDARIES | | | |

| # | Date Received | District | Submitted By | COI Summary | General Geographic Region | Approx Location for Map Pin | Approx Location Comments | COI Themes | Reference or Endorsement to Submitted Map? If Y, which one? | Is COI mappable? (Y/N) | Boundary Change Requested by Submitter (Y/N) | If YES, entire Commission will assess what considerations there are for applicable boundary/district changes | | |
|----|---------------|----------|--------------|--|--|-----------------------------|--|---|---|------------------------|--|--|------------------------------------|-------|
| | | | | | | | | | | | | Boundary Change Recommended by Cx (Y/N) | Rationale for Recommendation by Cx | Notes |
| 53 | 11/16/2021 | 2 | Betsy Morris | I am a 30 year old resident of historic West Berkeley (split between District 1 and 2), and a current member of the Poet's Corner Advocates for the Unhoused and the Berkeley Visionary Equity Alliance. We want an inclusive community, and are working with existing institutions like Women's Day Time Drop In Center and Youth Spirit Artworks to recognize the massive displacement of the Black and Hispanic community members. We support a variety of truly affordable housing. strategies to reintegrate, including "good neighbor" shelters, tiny home villages, and safe parking lots while more affordable housing can be built. | Current boundaries work well (University, Sacramento, and Dwight Way). Strawberry Creek Park neighborhood with Berkeley Youth Alternatives, the park, the corp yard, Daytime Drop In Center and Strawberry Creek Lodge, Berkeley Youth Alternatives, belong in District 2. West Berkeley from south of University Avenue, to the Marina, Aquatic Park and east to Sacramento Street (the old de facto "color line" reflect. I am suprised to see the decline of West Berkeley and the Oceanview Neighborhood in favor of "South West Berkeley" and Northwest Berkeley." San Pablo Park was/is a distinctive neighborhood. The displacement of Black neighbors is striking west of San Pablo - the current census map looks scrubbed. | 2246 San Pablo Ave, 94702 | Used Intersection of San Pablo Avenue & Bancroft Way | SHELTERS; DIVERSITY; DISTRICT INEQUITY; HOMELESSNESS; INADEQUATE REPRESENTATION; AFFORDABLE HOUSING; DISPLACEMENT OF COMMUNITIES OF COLOR | | YES | MAINTAIN CURRENT BOUNDARIES | | | |
| 54 | 11/24/2021 | 4 | | and Arch Streets were split down the middle. Those who lived on the westside of the street were put into District 4, while those who lived on the East side of the street remained in District 6. Before, when we had common problems, we could go to our District 6 representative. Now, while we may have common problems--traffic, trash pick-up, lighting for the street, we now have to go to two different District representatives, even though we have the same problem. District 4 does not serve our needs. It is more oriented to Berkeley businesses. I always have had good responses from District 6 and still receive their newsletter. That's where I find out what is going on in Berkeley. I asked to be put on a District 4 newsletter, but it may be they don't have one. District 6 should continue south to Hearst | Lower Spruce area including Spruce Street and Arch Street | | | TRANSPORTATION SAFETY; LIGHTING; CRIME; TRASH-PICK; WATER RUN-OFF; INADEQUATE REPRESENTATION | | YES | Yes, District 6 should continue south to Hearst and west to Oxford, instead of a little chunk being taken out and added to District 4. Fix what you messed up last time and return us to District 6. We wanted to remain in District 6. District boundaries should be at large arteries, e.g. Hearst or Oxford | | | |

| # | Date Received | District | Submitted By | COI Summary | General Geographic Region | Approx Location for Map Pin | Approx Location Comments | COI Themes | Reference or Endorsement to Submitted Map? If Y, which one? | Is COI mappable? (Y/N) | Boundary Change Requested by Submitter (Y/N) | If YES, entire Commission will assess what considerations there are for applicable boundary/district changes | | Notes |
|----|---------------|----------|--------------|-------------|--|-----------------------------|--------------------------|---|---|------------------------|--|--|------------------------------------|-------|
| | | | | | | | | | | | | Boundary Change Recommended by Cx (Y/N) | Rationale for Recommendation by Cx | |
| 55 | 11/25/2021 | 4 | | | Cedar to the North, Hearst to the South, Oxford to the West and Euclid to the East | | | NEIGHBORHOOD COHESIVENESS; OWNER-OCCUPIED SINGLE FAMILY HOMES GROUPED TOGETHER; SMALL ADJUSTMENTS TO THE EXISTING DISTRICT MAP; RETIRED POPULATION; YOUNG FAMILIES; HOMEOWNER / LONG-TERM RESIDENTS VS STUDENT CONSTITUENCY | | YES | Yes, Move from District 4 to District 6 (unite with the rest of homeowning neighbors. Want south side of Virginia Street added to District 6); "Our neighborhood is roughly bordered by Cedar to the North, Hearst to the South, Oxford to the West and Euclid to the East. Currently our neighborhood is divided into at least three separate districts." | | | |
| 56 | 11/29/2021 | 8 | | | Willard Neighborhood - Ashby to Dwight and Telegraph to College Avenue | | | NEIGHBORHOOD COHESIVENESS | | YES | Yes, WANTS ALL OF WILLARD NEIGHBORHOOD TO BE IN DISTRICT 8; "The Willard neighborhood runs from Ashby to Dwight and from Telegraph to College. To me it makes common sense that a given neighborhood is within one voting district" | | | |

| Map Identification | | | | | | | | | | | | | | | Mapping Request(s) | | | DRAFT Map Inclusion | Final Map Inclusion |
|--------------------|---|----------------------|---|---|--|--|--|--------------------------------|--------------|------------|----------------------------------|---|-----------------------------|------------------------------|--------------------|-----------------------------------|---------------------|---------------------|---------------------|
| Map # | Map Name | District(s) Affected | Narrative Summary | Map Highlights & Themes | Public Communications Related to Submitted Map | Does it contradict Communities of Interest | Topography Considered | Geography Considered | Cohesiveness | Contiguity | District Integrity & Compactness | Utilizes Easily Understood Boundaries | Population Lowest Deviation | Population Highest Deviation | Total Deviation | Summary of Major Boundary Changes | IRC Action(s) Taken | IRC Decision | |
| 1 | 01_2021-10-08 Howard Rosenberg | 7 and 8 | Please include in dist. 8 this small area that was carved out and placed in dist. 7 to include farmer home of K. Worthington when he was in office. | Neighborhood Cohesion and Compactness Magnitude submission does not reflect the narrative. Map is unchanged. | | | Yes - uses existing map | Yes - uses existing map | Yes | Yes | Yes | Yes - Uses Telegraph Avenue as boundary | -5.95% | 6.96% | 13% | | | | |
| 2 | 02_2021-10-12 Anonymous A | All 8 | Re: Northside population #s - There is no way this is correct. Pop in Northside is at least 7000 | Major reconfigurations of all districts | | | No - Splits hills amongst different districts | No - splits Cal campus in half | No | Yes | No | No | -13.51% | 18.08% | 32% | | | | |
| 3 | 03_2021-10-19 Anonymous B-1 | All 8 | None | Major reconfiguration of districts 4 through 7; creation of two student districts (Dist 4 and 7); changes Dist 4 and 7 to E-W orientation; removes thousand oaks from Dist 5, combines DT and University, decreases Dist 7 and limits to area S of Campus | | | No - Did not include topography to draw boundaries | | No | Yes | No | No | -9.74% | 10.74% | 20% | | | | |
| 4 | 04_2021-10-19 Anonymous B-2 | | | | | | | | | | | | -24.85% | 21.99% | 47% | | | | |
| 5 | 05_2021-10-19 Anonymous B-3 | | | | | | | | | | | | -5.24% | 5.75% | 11% | | | | |
| 6 | 06_2021-10-25 Anonymous B-4 | | | | | | | | | | | | -4.36% | 5.75% | 10% | | | | |
| 7 | 07_2021-10-26 Troy Kaji | | | | | | | | | | | | -38.27% | 14.77% | 53% | | | | |
| 8 | 08_2021-10-28 Alfred Twu Map 1 | | | | | | | | | | | | -1.00% | 1.01% | 2% | | | | |
| 9 | 09_2021-10-31 Alfred Twu Map 2 | | | | | | | | | | | | -1.00% | 0.53% | 2% | | | | |
| 10 | 10_2021-11-01 Stephen Young | | | | | | | | | | | | -0.23% | 0.20% | 0% | | | | |
| 11 | 11_2021-11-02 Anonymous B-5 | | | | | | | | | | | | -15.37% | 16.57% | 32% | | | | |
| 12 | 12_2021-11-04 Phil Allen | | | | | | | | | | | | -9.03% | 5.96% | 15% | | | | |
| 13 | 13_2021-11-06 Bruce Stangeland | | | | | | | | | | | | -3.97% | 5.73% | 10% | | | | |
| 14 | 14_2021-11-06 Thomas Lord | | | | | | | | | | | | -0.50% | 0.26% | 1% | | | | |
| 15 | 15_2021-11-06 Lissa Miner | | | | | | | | | | | | -1.79% | 2.18% | 4% | | | | |
| 16 | 16_2021-11-11 Berkeley Progressive Alliance | All 8 | We re-affirm the integrity of the following communities of interest: District 2 and 5 include South Berkeley Historically African American neighborhoods, and include the following communities: San Pablo Park, West Berkeley, the Adeline Corridor, Loma LaCanta and Berman District 1 encompasses Northwest Berkeley Gilman, 4th Street, and North Berkeley communities, District 4 east of Central Berkeley McGee Spaulding, North Shattuck and Downtown communities District 7 respects Berkeley traditional student district including the predominantly student parts of the Northside District 8 has Southeast Berkeley Panza Hill, Elmwood and Claremont neighborhoods District 5 includes Central North | Neighborhood integrity | | | Splits Poets Corner | | Yes | Yes | Yes | No | -2.39% | 2.36% | 5% | | | | |
| 17 | 17_2021-11-12 BNC (Janis Ching) | All 8 | | See description (add here) | | | Partial | | Yes | Yes | Yes | Yes | -3.61% | 4.38% | 8% | | | | |
| 18 | 18_2021-11-12 Sheryl Drinkwater | | | | | | | | | | | | -4.78% | 6.96% | 12% | | | | |
| 19 | 19_2021-11-14 Alfred Twu Map 3 | | | | | | | | | | | | -3.91% | 4.33% | 8% | | | | |
| 20 | 20_2021-11-14 Ben Gould | | | | | | | | | | | | -2.73% | 6.17% | 9% | | | | |
| 21 | 21_2021-11-15 Anonymous | | | | | | | | | | | | -16.09% | 11.49% | 11% | | | | |
| 22 | 22_2021-11-15 RCJR | | | | | | | | | | | | -2.39% | 2.66% | 5% | | | | |
| 23 | 23_2021-11-15 West Berkeley Business District | | | | | | | | | | | | -2.55% | 3.94% | 6% | | | | |
| 24 | 24_2021-11-15 Kelly Hammargren Map 1 | | | | | | | | | | | | -0.72% | 0.52% | 1% | | | | |
| 25 | 25_2021-11-15 Kelly Hammargren Map 2 | | | | | | | | | | | | -0.44% | 0.29% | 1% | | | | |
| 26 | 26_2021-11-15 ASUC (Riya Master) | | | | | | | | | | | | -0.66% | 0.68 | 68% | | | | |
| 27 | 27_2021-11-15 Gregory Magofna | | | | | | | | | | | | -2.64% | 2.56% | 5% | | | | |
| 28 | 28_2021-11-15 Berkeley Citizens Action (BCA) | | | | | | | | | | | | -2.39% | 2.66% | 5% | | | | |
| 29 | 29_2021-11-15 Alfson & Holland | | | | | | | | | | | | N/A | N/A | N/A | | | | |



No Material
Available for
this Item

There is no material for this item.

City Clerk Department
2180 Milvia Street
Berkeley, CA 94704
(510) 981-6900

The City of Berkeley Independent Redistricting Commission Webpage:
<https://www.cityofberkeley.info/irc/>

Sun 12/5/2021 6:05 PM

RONALD CHOY ronald.choy@comcast.net

Re: my ideas for draft maps -- last CORRECTION and ADDITION

fixed one small double counting error. too many little pieces in A&H. I fixed it in the text below. Trash the earlier versions and use this one. Ron

On 12/05/2021 5:21 PM RONALD CHOY <ronald.choy@comcast.net> wrote:

I added a bit to Hills. Instead of Solano as the border, use Marin, the rationale being what A&H advocate. Solano is the commercial center of the community so both sides of the street should be in the same district. Marin make a better border because it has no commercial section and lots of fast traffic. I added to the text below. Trash both earlier versions and use this one. Ron

On 12/05/2021 4:24 PM RONALD CHOY <ronald.choy@comcast.net> wrote:

I found a small error: wrong street. I fixed it in the text below. Trash the earlier version and use this one. Ron

On 12/05/2021 11:34 AM RONALD CHOY <ronald.choy@comcast.net> wrote:

5 dec21

To: Team (RC)²G²D, Mark Numainville

Fr: Ron Choy

cc: Independent Redistricting Commission

Subj: MY DRAFT of Two Student-Majority Districts, Flatlands District, Hills District

These are my notes about my ideas for draft maps.

TWO STUDENT-MAJORITY DISTRICTS

The IRC has received several COI statements and maps that propose two student-majority districts for areas near the campus. The basic argument for two such districts is that the guestimated number of students who live in Berkeley is enough to make two districts. There are about 35,000 students enrolled. Many live in Berkeley close to campus. Enough live close to campus that they would constitute a majority in two districts.

Southside

One student district would be include Southside. The population in blocks between Oxford and Panoramic Hill and between Bancroft and Derby is large enough to make more than one district so an issue is where to draw the border.

On the east side, Prospect Street is the current border, which splits the west and east sides of the street. To me, both sides of the street are one community of interest [it would be good to receive a COI statement from this community verifying or debunking my opinion]. The east-uphill side of Prospect Street is in census block 4227-1003, population 618, which goes all the way to the city border. I would guess that the vast majority of the 618 are students since the both sides of the street are lined with Greek houses, student co-ops, and student-heavy apartment buildings. PROBLEM: We cannot split census blocks so including this census block with the student district would cut off Panoramic Hill from Elmwood-Claremont, which is the nearest similar community of interest. Point of fact: except for Prospect Street and the lowest section of Panoramic Way, the most of the census block is vacant campus property, and the vacant Smyth House in the only structure remaining after the campus razed the Smyth-Fernwall dorms. The SE corner

has a few private structures. RECOMMENDATION FOR FUTURE ACTION: Ask Census Bureau to split this block.

On the west side, the border has to be Dana or Telegraph. Using Dana would place all the dorms in one district. Using Telegraph would split off Unit 3 from Units 1 and 2, which are on College Avenue. If Telegraph were to be the border, then an obvious solution to this problem, if it is a problem, is to go around the Unit 3 block, census blocks 4228-2001, population 8, and 4228-2002, population 1443.

The north side border would be Bancroft Way and include the I House and the student co-ops uphill-behind it, census block 9821-1005, population 665, which would have to include the stadium since it is in this census block. This is a small problem because I assume that no one lives in the stadium, but RECOMMENDATION FOR FUTURE ACTION: Ask Census Bureau to split this block.

The south side border should be Derby Street, which would include Clark Kerr campus. This campus has three communities of interest: [a] students in census block 4237-1001, population 1089; [b] faculty housing in census blocks 4237-1000, population 57; and [c] Redwood Garden senior housing in census block 4237-1008, population 168. The students clearly are part of the Southside community. I think that the faculty and seniors are more closely aligned with Elmwood-Clairemont across Derby Street, which would split the campus along Sports Lane and South Street.

Northside and West Side of Campus

A second student-majority district would include Northside, the west side of campus, and abut the north and west borders of the Southside student district, sort-of a Big C, for Cal. This district would include LBL and the campus, which would finally unite the split parts of Foothill Housing Complex in one district and include Bowles Hall with Northside.

Side note about census block 9821-1001: This census block includes half of the Foothill Housing complex*, Bowles Hall, and LBL. The students should be separated from the lab. RECOMMENDATION FOR FUTURE ACTION: Ask Census Bureau to split this block.

* The other half is across Hearst Avenue in census block 4225-2007, which is partly why the two parts of the complex are in different districts.

The north border would be Cedar Street. The west border would be Milvia Street, which is the east border of a redrawn Flatlands district proposed by Alfsen and Holland in COI #50 and Map #29 [see below]. The south border would be Dwight Way to Telegraph Avenue. Going farther south to Derby Street would take a bite out of South Berkeley and would split off the northern part of LeConte neighborhood, which obviates this option.

A picture of this map is attached.

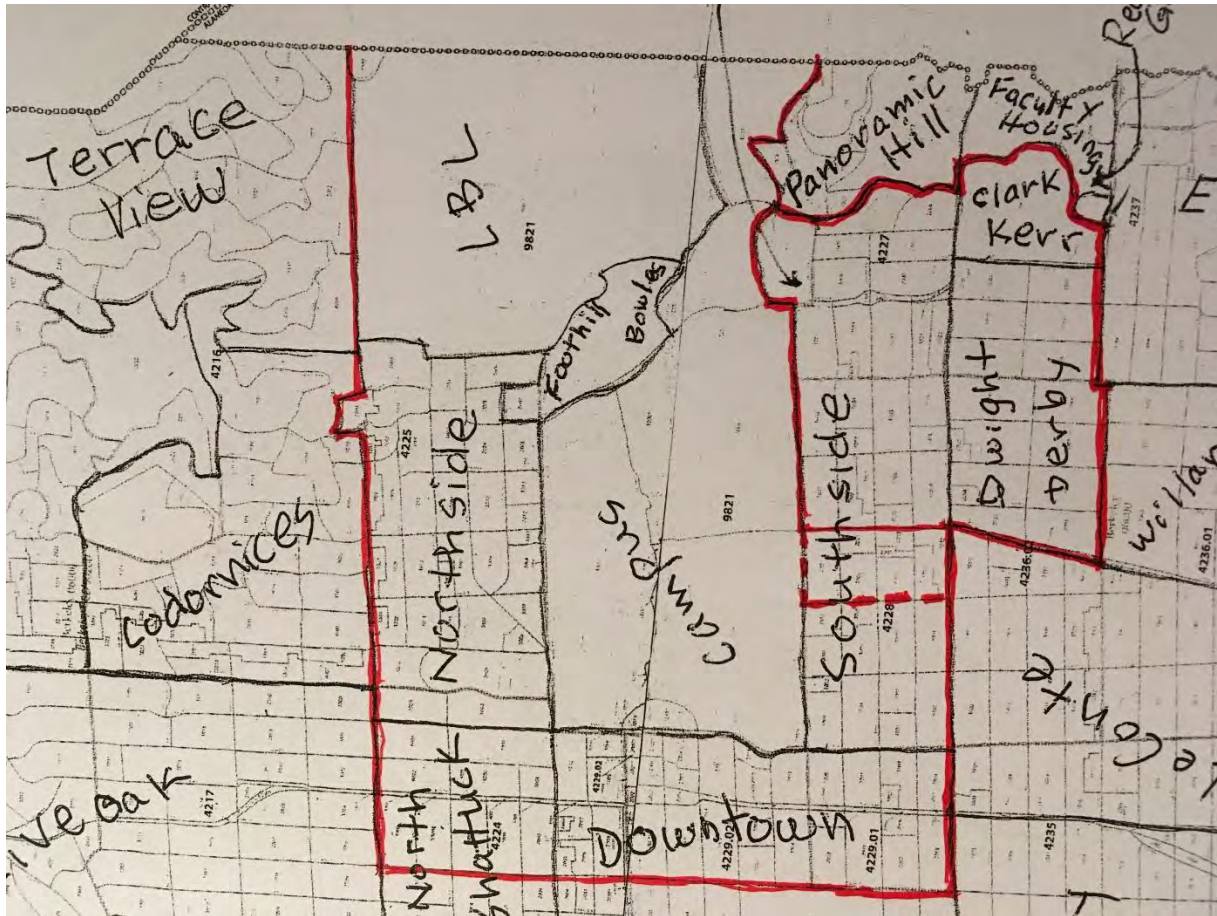

GREATER FLATLANDS DISTRICT

Alfsen and Holland, in their COI #50 and Map #29 [see picture attached], propose a district that covers the Greater Flatlands community of interest. The core of this district is a rectangle. The north border is Cedar Street, from Milvia Street to Sacramento Street. The west border is Sacramento Street, from Cedar Street to Dwight Way or Derby Street. The south border is Dwight Way or Derby Street. The 11,139 population in this core rectangle is not enough to make one district so A&H propose extending the core to the east, west, or south.

The east extension would overlap the Big C student district so that would obviate this option. The south extension past Dwight Way would take a substantial chunk out of South Berkeley, which I think would obviate this option. The west extension would cut Poets Corner in half, which that community of interest would surely strenuously oppose. Without the east and south extensions, half of Poets Corner would not make the population big enough so I propose locating all of Poets Corner in this district [census tract 4231, population 4,337], which is enough to make one district [$15,476 = 11,139 + 4,337$]. For purposes of keeping this section of University Avenue as a commercial center of the neighborhood rather than using it as a district border, a piece of A&H's west extension includes a rectangle across University Avenue north of Poets Corner, bounded by Hearst Avenue, Sacramento Street, University Avenue, and Bonar Street [census blocks 4222-2005, 6, ... 10, population 584], which would possibly keep the district within the acceptable deviation range. $16,060 = 11,139 + 4,337 + 584$.

NB: These population sums are probably not exactly correct because I added up individual census blocks and could easily have made an error. But I am confident that they are close enough.

A picture of this proposal is attached.

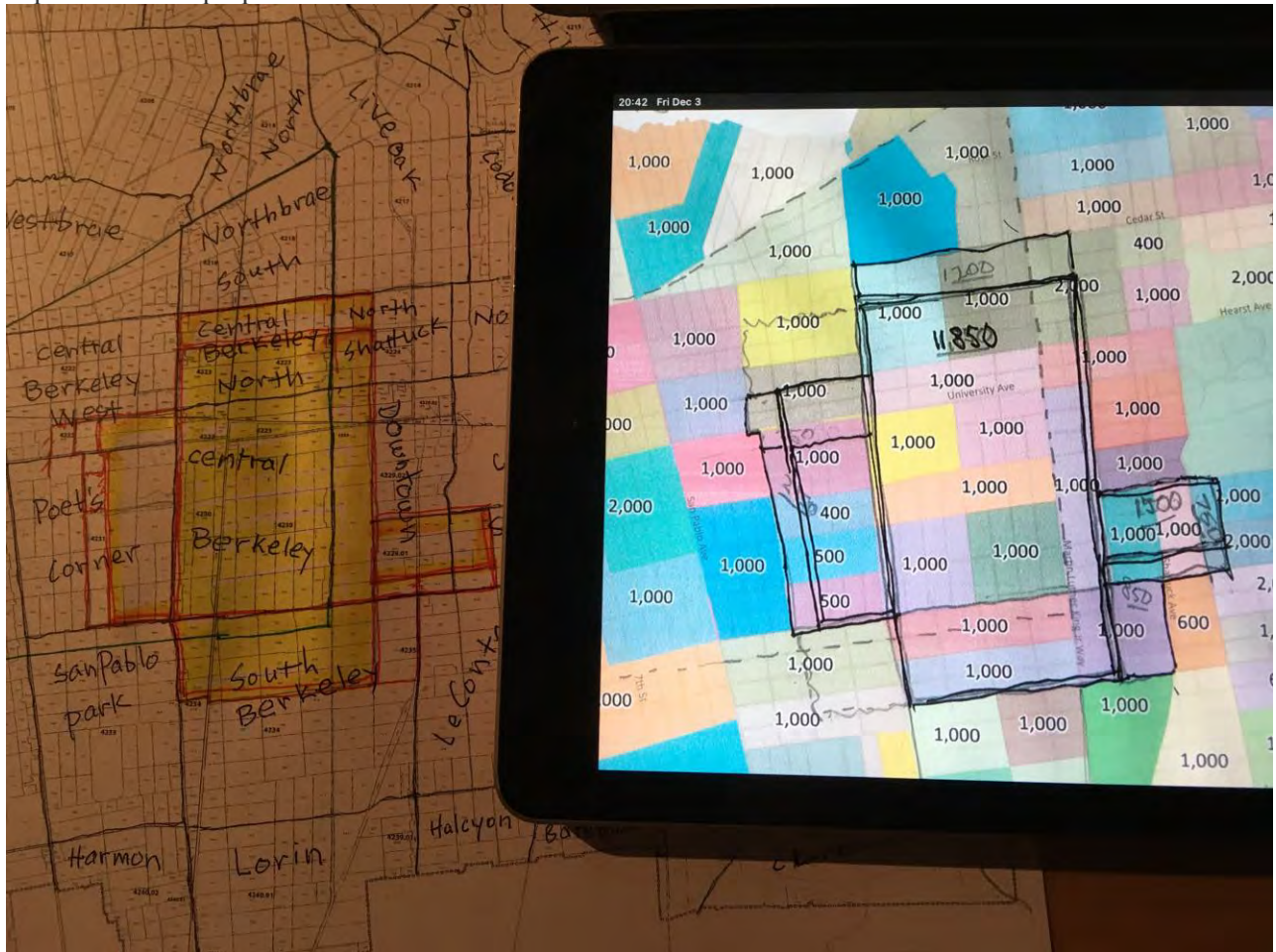



HILLS

If the above the Big C student district were selected, then the Hills would need an addition. Seventeen of the submitted proposed maps use some combination of Spruce Street, Oxford Street, and The Arlington as the west border of the Hills, and most of these include Northside with the Hills. Nine other maps draw the Hills extending west to Solano Avenue. Map Anon C, map #21, is the most straight forward example of this. A picture is attached. The border is Cedar Street, Spruce Street, Los Angeles to the Marin Circle, and Solano Avenue. The population in this area is 15,914.

Solano Avenue is the commercial center of its community, and both sides of the street should be in the same district. Marin Avenue would be a better border from the Marin Circle west. It is a true major traffic artery and no commercial section. Shifting the border to Marin Avenue adds 377 to the population, bringing the total to 16,291. Being on the large side now would be serve it well in the coming decade since I expect it to continue be the slowest growing area.

District: 6

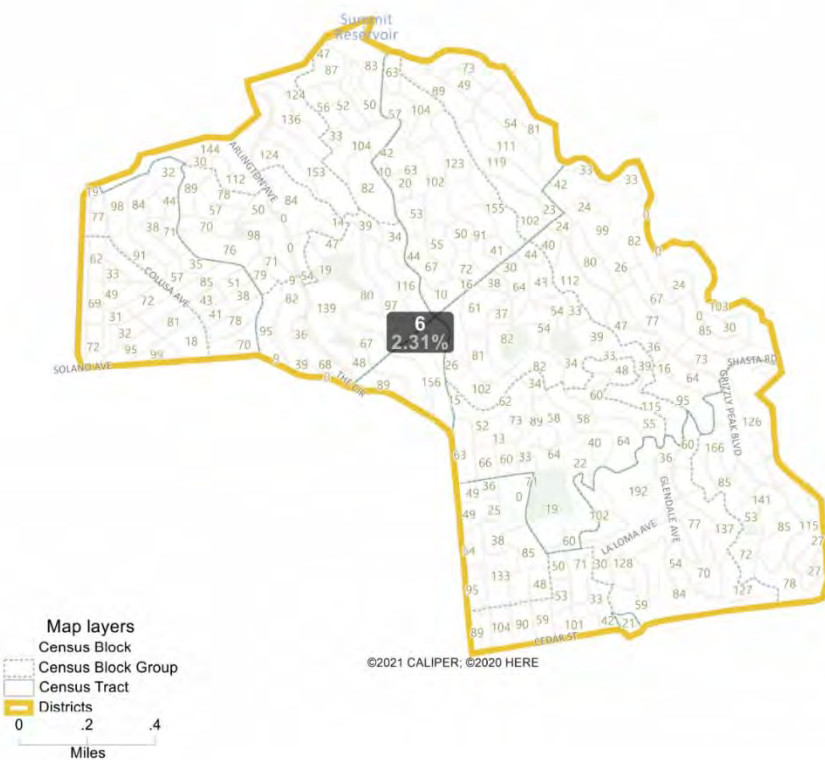

| Field | Value |
|---------------------|---------|
| District | 6 |
| PPA_Population | 15914 |
| Deviation | 360 |
| % Deviation | 2.31% |
| PPA_Hispanic_Origin | 1036 |
| PPA_Hispanic_Origin | 6.51% |
| PPA_White | 11422 |
| % PPA_White | 71.77% |
| PPA_AfAm | 301 |
| % PPA_AfAm | 1.89% |
| PPA_AiAn | 5 |
| % PPA_AiAn | 0.03% |
| PPA_Asian | 1772 |
| % PPA_Asian | 11.13% |
| PPA_HoPI | 16 |
| % PPA_HoPI | 0.1% |
| PPA_Other | 139 |
| % PPA_Other | 0.87% |
| PPA_CVAP_19 | 11888 |
| % PPA_CVAP_19 | 74.7% |
| PPA_Hsp_CVAP_19 | 508 |
| PPA_Hsp_CVAP_19 | 4.27% |
| A_NH_Wht_CVAP_19 | 9361 |
| A_NH_Wht_CVAP_19 | 78.74% |
| A_NH_BlK_CVAP_19 | 241 |
| A_NH_BlK_CVAP_19 | 2.03% |
| A_NH_Ind_CVAP_19 | 4 |
| A_NH_Ind_CVAP_19 | 0.03% |
| A_NH_Asn_CVAP_19 | 1352 |
| A_NH_Asn_CVAP_19 | 11.37% |
| A_NH_Hwn_CVAP_19 | 24 |
| A_NH_Hwn_CVAP_19 | 0.2% |
| †-18 HU_Occupied | 6422.00 |
| †-18 Owner occupied | 5392.00 |
| †-18 Owner occupied | 83.96% |

SUMMARY

The above four districts are:

- Flatlands, District 4
- Big C, District 5
- Southside, District 7
- Hills, District 6

Fitting in the remaining districts requires setting the size of the two student districts low enough to keep all districts within the acceptable deviation spread.

unrelated to the above

UNDERCOUNT

The table below compares the official 2020 and 2010 populations by census tract. These are the data we must use. I've marked in red the changes that look to me like undercounts that matter. When Southside, [census tract 4228] goes up 34%, and student-dense Piedmont/Parker-LeConte-Willard [census tracts 4236.01 and 4236.02], Northside [census tract 4225], North Shattuck [Gourmet Ghetto, census tract 4224] hardly change, it looks wrong to me.

Recall that the campus closed in March 2020, and the census count is for 1 April 2020. It is my understanding that students in campus housing are counted at their campus housing address. Where students living in private rentals are counted is a mystery to me.

| official census | | | | | | |
|-----------------|--------------|-------------|-------------|-----------|-------|----------------------------|
| 14073 | 15554 | 1482 | <-ave | | | |
| 112580 | 124432 | 11852 | 11% | <-total | | |
| 2010 | 2020 | Δ | % Δ | tract | dist | neighborhood |
| 3632 | 3906 | 274 | 8% | 4219 | 1,5 | Westbrae |
| 3144 | 3324 | 180 | 6% | 4222 | 1 | Cent B nw |
| 2685 | 2848 | 163 | 6% | 4221 | 1 | West B n |
| 1756 | 4163 | 2407 | 137% | 4220 | 1,2 | West B n&s |
| 2794 | 2891 | 97 | 3% | 4232 | 2 | West B s |
| 3964 | 4337 | 373 | 9% | 4231 | 2 | Poet's |
| 17975 | 21469 | 3494 | 19% | | | |
| 3647 | 3748 | 101 | 3% | 4233 | 2 | San Pablo Park |
| 2172 | 2494 | 322 | 15% | 4240.02 | 2 | Harmon |
| 4685 | 5074 | 389 | 8% | 4234 | 3 | South Berkeley |
| 3118 | 3476 | 358 | 11% | 4235 | 3 | South Berk, Lorin |
| 3716 | 4154 | 438 | 12% | 4240.01 | 3 | Lorin |
| 17338 | 18946 | 1608 | 9% | | | |
| 4196 | 4137 | -59 | -1% | 4224 | 4,5 | N Shatt, DT |
| 1989 | 2323 | 334 | 17% | 4229.01 | 4 | DT |
| 2347 | 3035 | 688 | 29% | 4229.02 | 4 | DT |
| 4396 | 4679 | 283 | 6% | 4230 | 4 | Cent B |
| 3387 | 3815 | 428 | 13% | 4223 | 4,5 | Cent B n |
| 16315 | 17989 | 1674 | 10% | | | |
| 3844 | 3949 | 105 | 3% | 4213 | 5 | Northbrae n, 10K Oaks |
| 1593 | 1679 | 86 | 5% | 4214 | 5 | Live Oak n, Crag |
| 3198 | 3386 | 188 | 6% | 4217 | 5 | Live Oak s |
| 2007 | 2113 | 106 | 5% | 4218 | 1,4,5 | Northbrae s |
| 4658 | 5066 | 408 | 9% | 4225 | 6 | Northside |
| 15300 | 16193 | 893 | 6% | | | |
| 3563 | 3659 | 96 | 3% | 4212 | 5 | S Hampt, 10K Oaks |
| 1992 | 2033 | 41 | 2% | 4211 | 6 | S Hampton, Crag |
| 3640 | 3747 | 107 | 3% | 4215 | 6 | B Hills, Crag |
| 3558 | 3837 | 279 | 8% | 4216 | 6 | B Hills |
| 12753 | 13276 | 523 | 4% | | | |
| 552 | 354 | -198 | -36% | 4226 9821 | 7 | Northside |
| 0 | 0 | 0 | #DIV/0! | 4226 9821 | 6 | LBL |
| 28 | 25 | -3 | -11% | 4226 9821 | 8 | Panoramic |
| 635 | 665 | 30 | 5% | 4226 9821 | 8 | I House |
| 1215 | 1044 | -171 | -14% | | | |
| 8368 | 11245 | 2877 | 34% | 4228 | 7 | Southside |
| 4885 | 4872 | -13 | 0% | 4227 | 8,7 | LBL, Pano, Southside |
| 13253 | 16117 | 2864 | 22% | | | |
| 2642 | 2825 | 183 | 7% | 4236.01 | 7 | LeConte, Willard |
| 5659 | 5620 | -39 | -1% | 4236.02 | 3,7,8 | LeConte, Willard, PiedPark |
| 3633 | 4236 | 603 | 17% | 4237 | 8 | Elmwood, ClkKerr |
| 2925 | 3217 | 292 | 10% | 4238 | 8 | Elmwood, Claremont |
| 2020 | 2036 | 16 | 1% | 4239.01 | 3,8 | Halcyon, Lorin |
| 1552 | 1464 | -88 | -6% | 4239.02 | 8 | Bateman, Halcyon |
| 18431 | 19398 | 967 | 5% | | | |
| endsum | endsum | endsum | | | | |

From: [RONALD CHOY](#)
To: [Numainville, Mark L.](#)
Cc: [ChoRana](#); [Lupe Gallegos-Diaz](#)
Subject: coi 50, flatlands. 2 students
Date: Friday, December 3, 2021 10:56:43 PM

WARNING: This is not a City of Berkeley email. Do not click links or attachments unless you trust the sender and know the content is safe.

Mark:

I read Alfsen&Holland slowly so I could reproduce their map just from the text. Since A&H ask directly for a reconfigured D4, would you please ask Makinde to work up the numbers for each of the sections so that we can add to the core or not each extension separately.

Based on the map, which differs here and there from the text:

- Core contained within Virginia, Milvia, Derby, Sacramento
- North extension within Virginia, Milvia, Cedar, Sacramento
- Southern section of core within Milvia, Derby, Sacramento, Dwight
- West extension 1.1 within Sacramento, Hearst, West, Addison
- West extension 1.2 within West, Hearst, Bonar, Addison
- West extension 2.1 within Addison, West, Dwight, Sacramento
- West extension 2.2 within Addison, Bonar, Dwight, West
- [this means that D2 loses half of Poets Corner]
- East extension 1 within Milvia, Haste, Ellsworth, Bancroft
- East extension 2 within Milvia, Dwight, Ellsworth, Haste
- [the east extensions won't work because they have to be part of the second student district]

If we choose this D4,

- reconfigure D7 a bit by extending it south of Dwight,
 - make a new D5 student district that forms a C from Northside around the west side of campus and the west end of Southside to Dana or Telegraph, [like Twu 2, Anon C, and Anon B5]
 - reconfigure the Hills [D6] by replacing Northside with 10K Oaks, [like Anon C and Anon B5]
- then we're left with the remains of D5 that have to join D1. [like Anon C]

Please ask Makinde to work up the numbers for the new D7, D5, and D6, too. Thanks.

We can work on D1, D2, D3, and D8 later.

Can share this with big subcommittee and other commissioners.

Ron





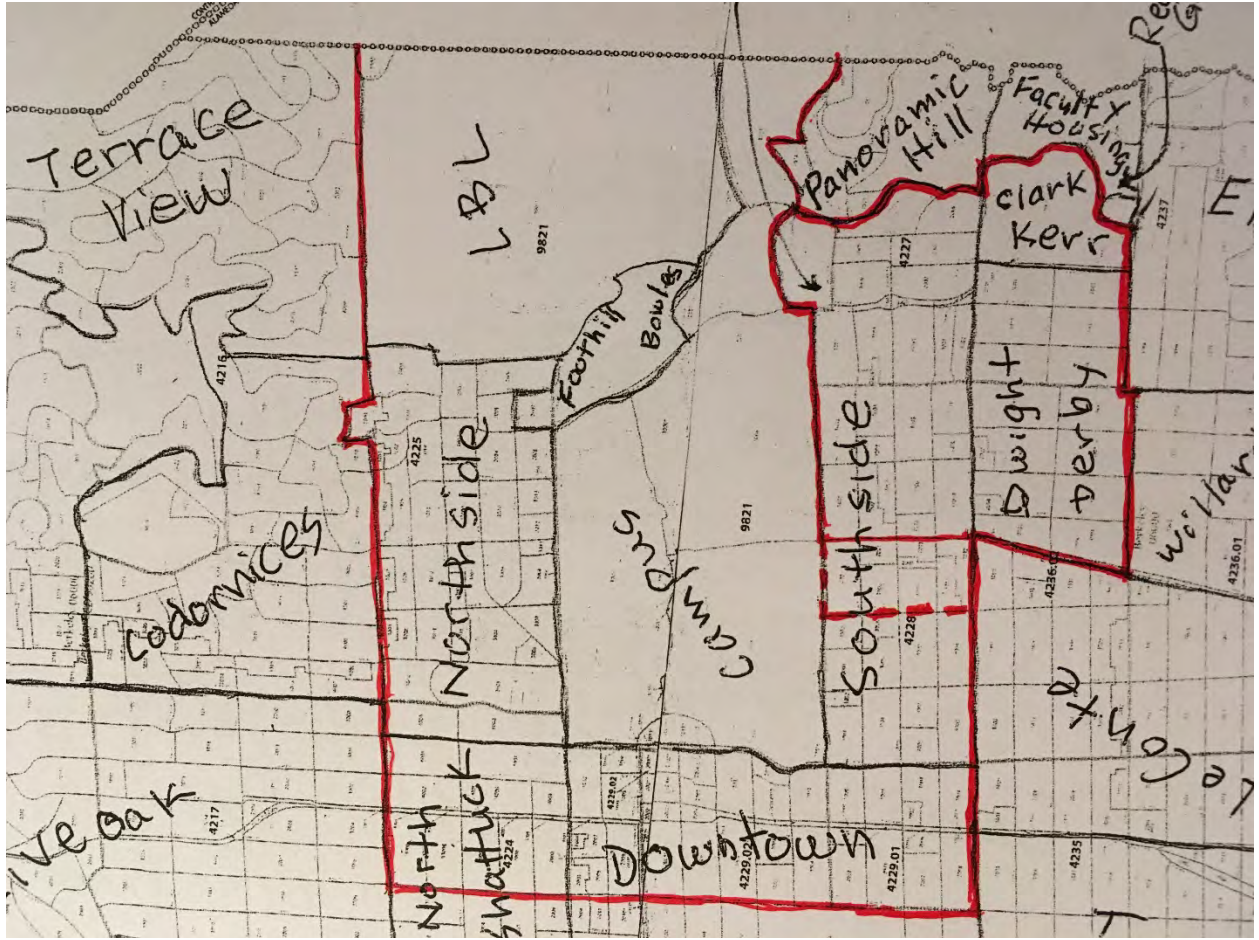

From: RONALD CHOY
To: ChoRana; Lupe Gallegos-Diaz; Numainville, Mark L.
Cc: Independent Redistricting Commission
Subject: LeConte, Bateman, Willard, Halcyon, DwightDerby/PiedmontParker neighborhoods
Date: Wednesday, December 8, 2021 3:59:06 PM

WARNING: This is not a City of Berkeley email. Do not click links or attachments unless you trust the sender and know the content is safe.

Team Team (RC)²G²D:

In preparation for our team meeting on Thursday, I send you my notes on neighborhoods that are problematic. These are neighborhoods that I know well because I have lived in Bateman since 1983.

Except for the "I think" paragraph and a couple of conclusions, this is in the public record so I'm not saying something that everyone already could know.

<https://redistricting-commission-berkeley.hub.arcgis.com/>

<https://www.cityofberkeley.info/irc/> meeting packet for each meeting.

Mark: I confirm that I would like to share these notes with the IRC. Ron

IRC has received 29 maps. Below is my quick and dirty list with notes about what each map does to LeConte, Bateman, Willard, Halcyon, DwightDerby/PiedmontParker neighborhoods. These are on, across, or near the borders of D3, South Berkeley; D7, Southside; and D8, Elmwood-Claremont.

- DDPP [betw Dw & Derb, Waring and Telegraph] is between Southside and Elmwood. The population of this rectangle of blocks is big, which is why it is really difficult to put it in the same district as Southside. If one had to split this area, then the obvious choices are Parker [EW] or Piedmont or Hillegass [NS].
- LeConte is currently divided among D3, D7, and D8. Its diverse population is substantial.
- Willard and DDPP are currently divided between D7 and D8; the Kriss gerrymander, legal at the time.
- Halcyon is currently divided between D3 and D8 [this might be the result of being in two census tracts that neatly divide the neighborhood in half].
- Bateman is now in D8, but as a possible consequence of the error in the neighborhood map produced by Redistricting Partners, the IRC consultants, at least three map makers have cut Bateman in two at Regent Street, putting the west half in D3 and keeping the east half in D8 [BPA #16, RCJR #22, BCA #28]. Andy Johnson, BNA president, has written to the IRC about this [Redistricting Communications # 28?].
<https://www.dropbox.com/sh/jx3obvx644s8ass/AABNeaiAPeTgm6HWvAwqYVeTa?dl=0>.

By my count, only 7 of the 29 maps keep all these neighborhoods together [Anon A, Anon B1-4, Twu 1 & 2].

NB: neighborhood integrity is an important redistricting criterion, but it is just one of eight criteria, and no criterion trumps all the others. It's case by case analysis, balance, synthesize possibly conflicting criteria and public statements.

As of now, I think:

- Bateman is clearly the result of an error.
- Willard will probably be fixed.
- Halcyon can easily be fixed. small population, and it's just a matter of which district it goes in.
- DDPP is contentious because it is big.
- LeConte has been split since the beginning [see the old maps posted with COI #34, <https://www.dropbox.com/sh/x6p2q96if60elap/AAAWJQgxUMSskuG1AKbMZ-n7a?>

[dl=0&preview=034_2021-10-26.pdf](#)], and could easily remain split since its diverse population is substantial and it is already in three districts.

<https://www.dropbox.com/sh/2v5j07afc3vu002/AAD13TSzN5POD-Ds2SPLUf14a?dl=0>

- 1 Rosenberg: put Kriss back in 8
- 2 Anon A. all together
- 3-6 Anon B1-B4. all together
- 7 Kaji DDPP split
- 8-9 Twu 1&2 all together
- 10 Young LeC DDPP
- 11 Anon B5 LeConte ddpp split
- 12 Allen EW splits all
- 13 strangeland Halc Bateman Will in 3, LeConte in 3 & 8. ddpp in 8
- 14 lord will split. lec split. hhalc split
- 15 Miner ddpp split LeC Halc in 3
- 16 BPA Bateman split. Lec in 3
- 17 BNC LeC Hal in 3
- 18 Drinkwater all split
- 19 Twu 3 ddpp split. Lec split
- 20 Gould LeCon split
- 21 Anon C LeCon split
- 22 RCJR Bateman split. LeC ddpp spli
- 23 West Berk Business Lec split ddpp split
- 24 Hammergren1 Will Lec Halc ddpp split
- 25 Hammergren2 LeC Halc in 3
- 26 ASUC ddpp split. LeC Halc Bate Will in 8
- 27 Magofna LeC split
- 28 BCA LeC split ddpp split Bateman split
- 29 A&H only Flatlands

Bunting, Sarah K.

From: Vincent Casalaina <proberk@aol.com>
Sent: Wednesday, December 1, 2021 1:35 PM
To: sundial@sonic.net; Independent Redistricting Commission
Cc: halcyon92@gmail.com; bna-directors@googlegroups.com; ProBerk@aol.com; drm1a2@sbcglobal.net
Subject: Re: Major error on redistricting map
Categories: Communications

WARNING: This is not a City of Berkeley email. Do not click links or attachments unless you trust the sender and know the content is safe.

Andrew,

Thanks for catching this and bringing it to the attention of the Berkeley Redistricting Commission.

And a special thanks for including Willard and Halcyon in your comments.

Vincent Casalaina

-----Original Message-----

From: Andrew Johnson <sundial@sonic.net>
To: redistricting@cityofberkeley.info
Cc: halcyon92@gmail.com; BNA Board <bna-directors@googlegroups.com>; ProBerk@aol.com; drm1a2@sbcglobal.net
Sent: Tue, Nov 30, 2021 11:06 am
Subject: Major error on redistricting map

Members of the Redistricting Commission,

The map shown at https://www.cityofberkeley.info/uploadedFiles/Clerk/Level_3_-_Commissions/Berkeley%20COI%20NH2.pdf misidentifies the Bateman neighborhood, and must be corrected. The Bateman neighborhood is bounded by Ashby on the north, College on the east, Woolsey on the south, and Telegraph on the west. Your maps places us west of Telegraph, in the Halycon neighborhood.

The Bateman neighborhood is long-established by the above boundaries, and represents a strong community of interest. See our website at <http://www.batemanneighborhood.org>

Further, that map does not identify the Halycon neighborhood, nor the Willard neighborhood which is north of Ashby. Both are also long-established neighborhoods. You must correct these mistakes.

<https://www.halcyonneighborhood.org/>
<http://www.neighborhoodlink.com/Willard>

Thank for your attention to fixing these errors,

- Andrew Johnson, President, Bateman Neighborhood Association

Bunting, Sarah K.

From: greysonne coomes <draig68@yahoo.com>
Sent: Tuesday, December 7, 2021 7:29 PM
To: Independent Redistricting Commission
Subject: Redistricting (Elmwood/Willard)

WARNING: This is not a City of Berkeley email. Do not click links or attachments unless you trust the sender and know the content is safe.

Hi,

I am writing to request that, when you redistrict, you please not divide the Willard Neighborhood into little bits, and thus dilute our voice. Such tactics are in fact currently being used by the GOP (sic) on communities of color in Texas and places like that, and it would really be a shame to see the same from people of more advanced and evolved perspective. Please keep us a cohesive unit.

Thanks

Greysonne Coomes
2728 Benvenue Ave
Berkeley CA, 94705
(Willard Neighborhood Association)

Bunting, Sarah K.

From: Ching/Battles <battles.ca@sonic.net>
Sent: Wednesday, December 1, 2021 8:44 PM
To: Independent Redistricting Commission
Subject: Accurate Numbers

Categories: Communications

WARNING: This is not a City of Berkeley email. Do not click links or attachments unless you trust the sender and know the content is safe.

Dear Redistricting Commissioners,

I'm afraid my comment at tonight's meeting was completely misunderstood and took you all off on a tangent that was not at all what I intended. I wholeheartedly agree that UC students who live in Berkeley should be counted and deserve full representation in this process.

What I was asking for was a fair representation of the UC Berkeley population. I question the "fact" that one in 3 Berkeley residents is a UC student. To get that number, one must assume that the entire UC enrollment of 42,300 students live in our city. This is not the correct number to use, as many students live outside of the city. I urge you to stop using the one in three ratio unless the census data backs that up.

I was also trying to point out that parents are actually speaking not only for themselves, but also for the 12.5% of our population who are under the age of 18 and who had no direct input in this process, but would be directly affected by your decisions for the next 10 years. This was something I wanted you to consider if you weight the input received as I did not want this population to be counted less than the UC students.

I apologize that I was not as clear as I could have been. Thank you for all of your work to make this a fair and equitable process.

Sincerely,

Janis Ching
Berkeley Neighborhoods Council